

# High Pressure Ermeto EO/E02 Tube Fittings **40**

Bulkheads .....	499
Cone Plugs .....	515
Distance Piece Adaptors .....	505
EO & E02 Nuts .....	520
Port & Tube Plugs .....	516
Port Reducers .....	515
Pressure Gauge Adaptors .....	511
Reducers .....	497,498
Swivel to BSPP Straights.....	507
Swivel to Metric Parallel Straights.....	512
Swivel to Swivel .....	502,503
Tube End Reducers.....	504,505
Tube to BSP Banjos .....	510
Tube to BSP Locknut Adjustables .....	508,509
Tube to BSPP Straights .....	506,507
Tube to Metric Banjos .....	514
Tube to Metric Locknut Adjustables.....	513
Tube to Metric Parallel Straights .....	512
Tube to Metric Taper .....	514
Tube to Swivel O-ring Seal.....	500,501
Tube to Tube Unions .....	495,496
Tube to UNF .....	514
Weld Fittings .....	518,519

## EO Tube Fittings

EO (Ermeto Original) fittings are designed for metric tube. All threads, hexagons, bores and other dimensions are purely metric based on German Standards DIN3861, DIN3859 and DIN2353.

EO fittings are recognised for the high pressure performance of the small dimension body. EO fittings are available in the 3 series for low, medium and high pressures (LL, L and S-Series).



EO Progressive Ring Fitting

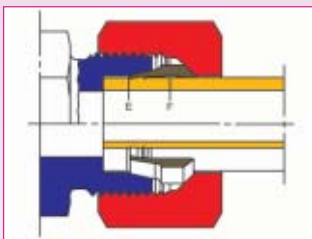

After tightening the nut

### Features:

- Field - Assembly - DPR fittings can be virtually assembled anywhere with just a couple of wrenches.
- Low - Cost Assembly - Using an EOMAT machine is the most economic method to pre-set DPR-rings onto tube ends.
- Available sizes - Most DPR-fittings are available in 25 sizes from 4 to 42mm tube OD.
- Tube Wall - EO fittings are suitable for use with light wall, medium wall, heavy wall and extra heavy wall tubing. (Light wall tube may require support sleeve VH).
- Tube Material - EO-bite type fittings can be applied on most tube material, such as high and low - grade steel or stainless steel, copper, aluminium or CuNiFe. Even plastic tubes such as nylon, polyurethane, PVC or PTFE can be easily connected by using support sleeves E.
- Low Torque - All nuts of EO fittings are coated with a highly effective lubricant.
- Temperature Rating - EO fittings are suitable for sub-zero through elevated temperature applications. Service temperature rating is limited by the material chosen.
- Compatibility - Since EO fittings can be manufactured from a wide range of metals, compatibility factor with various fluids and atmospheric conditions is extensive.

## EO-2 Fitting System

The EO-2 high pressure tube fitting generation is a recent development of the Parker Hannifin Tube Fitting Division. It was introduced in an effort to eliminate leakage in all fluid systems.

The common feature of all EO-2 fittings are elastomeric seals on all joints. This assures leakfree operation without retightening - even under severe working conditions.

EO-2 is a true metric design according to 24° bite-type standards such as : ISO 8434, DIN 2353 or DIN3861. It covers all 3 series (LL, L and S) of the broad EO tube fitting program.



EO-2: Safe - dry - clean

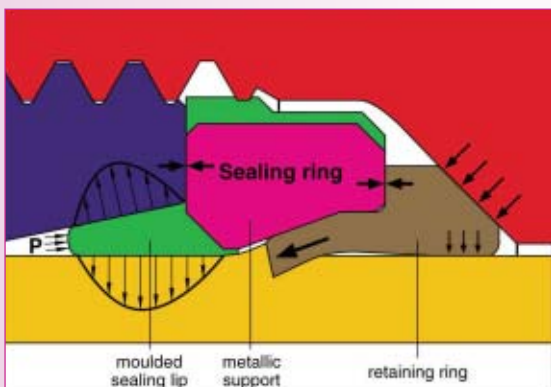

The metallic support of the sealing ring acts just like an integrated preassembly tool.

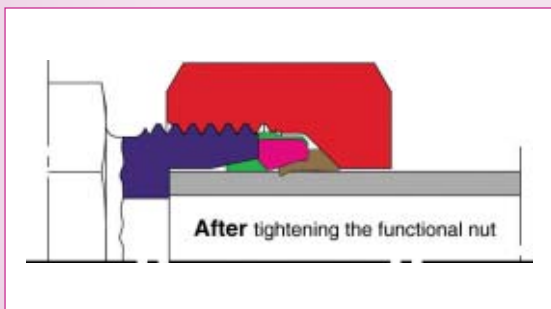

After tightening the functional nut

### Features:

In addition to the general advantages of the EO tube fitting system, the unique EO-2 fitting features even more specific benefits:

- Sealing capability - An elastomeric seal forms the primary sealing element, thus assuring leakfree sealing. Even low-viscosity media such as water or gas are hermetically sealed. Hydraulic systems therefore do not "sweat" at fittings.
- High pressure resistance - EO-2 Fittings are rated up to Pmax 900 bar.
- Durability - The elastomeric seal does not require any retightening even after years of operation under severe working conditions.

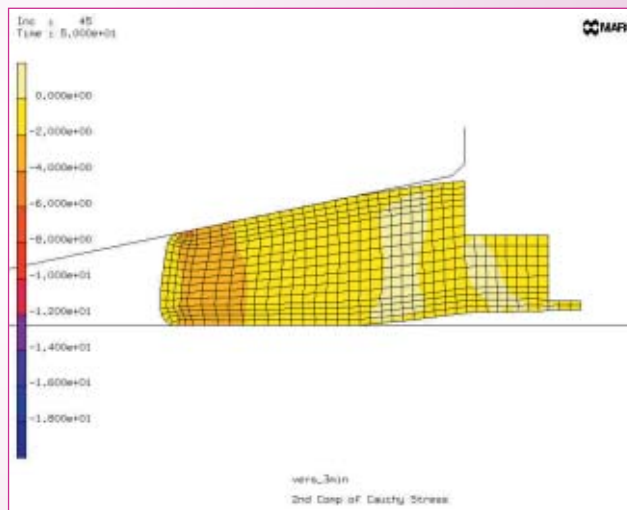

The metallic support of the sealing ring acts just like an integrated preassembly tool.

- Bite Control - The ideal bite depth is controlled by the fitting design rather than the fitters force.
- Functional Nut - Individual components such as the retaining ring or seal cannot be lost, forgotten, confused or assembled in the wrong orientation.
- Make-up - From the wrench-tight position of the pre-set EO-2 joint, one short pull on the wrench (approx. 1/6 to 1/4 turn) gives the assembly a quick high rise to required torque. EO-2 fittings have a solid "Hit-home-feel" and excellent over-torque resistance.
- Visible Inspection - There is no doubt if an EO-2 Functional nut has been pre-set correctly or not. Inspection is as simple as checking if the gap between retaining ring and sealing ring is completely closed.
- No Phantom Leaks - Lubrication is not mandatory for the assembly of steel EO-2 fittings. The machine operator will not be irritated about lubricant coming out of the fittings once the hydraulic system gets hot.
- Reusability/Remakeability - EO-2 fittings can be disassembled and reassembled many times.
- Interchangeability - The EO-2 functional nut can be used for the whole variety of the broad range of more 50 configurations in some 25 sizes of standard EO LL, L and S-series fittings.
- Reliability - Millions of EO-2 fittings are working trouble free in applications. Leakage does not occur on EO-2 pipework.
- Popularity - EO-2 fittings are as easy to assemble as traditional bite type fittings, but they eliminate most of their typical assembly problems.

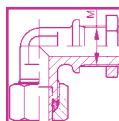
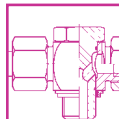

**TUBE FITTINGS HIGH PRESSURE - ERMETO EO/EO2**

**Tube to Tube Unions**

**G Union**

EO tube end / EO tube end.

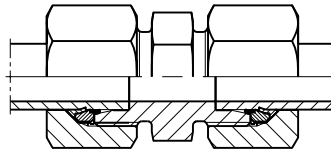

EO Fittings						EO-2 Fittings		
Code	Price	Tube O.D. (mm)	PN (bar)	P max (bar)		Code	Price	
<b>Extra Light Duty</b>								
HO117-0438	£1.62	4	100	250		HO113-0643	£3.30	
HO117-0439	£1.79	6	100	250		HO113-0589	£3.66	
HO117-0444	£1.84	8	100	250				
HO117-0447	£2.13	10	100	250				
HO117-0451	£2.54	12	100	250				
<b>Light Duty</b>								
HO117-0441	£1.59	6	315	500		HO113-0102	£3.25	
HO117-0445	£1.76	8	315	500		HO113-0104	£3.54	
HO117-0449	£2.06	10	315	500		HO113-0106	£4.29	
HO117-0452	£2.47	12	315	400		HO113-0108	£4.85	
HO117-0456	£3.43	15	315	400		HO113-0110	£6.56	
HO117-0458	£5.27	18	315	400		HO113-0112	£10.05	
HO117-0463	£7.22	22	160	250		HO113-0114	£13.13	
HO117-0467	£12.60	28	160	250		HO113-0326	£19.60	
HO117-0470	£17.28	35	160	250		HO113-0433	£29.89	
HO117-0473	£22.23	42	160	250		HO113-0478	£39.10	
<b>Heavy Duty</b>								
HO117-0442	£1.92	6	630	900		HO113-0103	£3.69	
HO117-0446	£2.15	8	630	900		HO113-0105	£4.06	
HO117-0450	£2.63	10	630	900		HO113-0107	£4.72	
HO117-0453	£2.98	12	630	900		HO113-0109	£5.70	
HO117-0454	£5.53	14	630	700		HO113-0642	£10.93	
HO117-0457	£5.72	16	400	630		HO113-0111	£9.96	
HO117-0460	£8.44	20	400	630		HO113-0113	£13.65	
HO117-0464	£13.81	25	400	630		HO113-0115	£21.79	
HO117-0469	£19.21	30	400	420		HO113-0116	£30.46	
HO117-0471	£26.04	38	315	420		HO113-0117	£40.32	

**W Union Elbow**

EO Tube End / EO Tube End

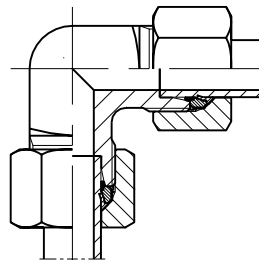

EO Fittings						EO-2 Fittings		
Code	Price	Tube O.D. (mm)	PN (bar)	P max (bar)		Code	Price	
<b>Extra Light Duty</b>								
HO117-1379	£3.68	4	100	250		HO113-0567	£5.29	
HO117-1380	£3.72	6	100	250		HO113-0568	£5.51	
HO117-1383	£4.06	8	100	250				
HO117-1356	£4.91	10	100	250				
HO117-1359	£5.66	12	100	250				
<b>Light Duty</b>								
HO117-1381	£3.65	6	315	500		HO113-0278	£5.24	
HO117-1384	£3.93	8	315	500		HO113-0280	£5.62	
HO117-1357	£4.21	10	315	500		HO113-0281	£6.36	
HO117-1360	£4.96	12	315	400		HO113-0382	£7.27	
HO117-1364	£6.72	15	315	400		HO113-0285	£9.74	
HO117-1367	£9.15	18	315	400		HO117-1602	£13.81	
HO117-1369	£12.84	22	160	250		HO113-0288	£18.56	
HO117-1372	£19.80	28	160	250		HO113-0290	£26.80	
HO117-1376	£28.62	35	160	250		HO113-0429	£41.22	
HO117-1378	£37.58	42	160	250		HO113-0293	£54.44	
<b>Heavy Duty</b>								
HO117-1382	£4.21	6	630	900		HO113-0279	£5.89	
HO117-1385	£4.47	8	630	900		HO113-0425	£6.32	
HO117-1358	£5.21	10	630	900		HO113-0282	£7.23	
HO117-1361	£5.86	12	630	900		HO113-0284	£8.50	
HO117-1362	£9.99	14	630	700		HO113-0569	£15.24	
HO117-1365	£9.48	16	400	630		HO113-0286	£13.59	
HO117-1368	£13.04	20	400	500		HO113-0287	£18.12	
HO117-1370	£20.93	25	400	500		HO113-0289	£28.90	
HO117-1374	£29.16	30	400	420		HO113-0291	£40.40	
HO117-1377	£41.74	38	315	420		HO113-0292	£55.38	

= Manufacturer's code **EXAMPLE** = Special Price

Tube to Tube Unions

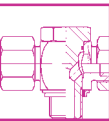

SECTION  
40

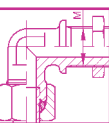

Online order  
www.lister.co.uk



## Tube to Tube Unions

### T Union Tee

All 3 ends EO tube end

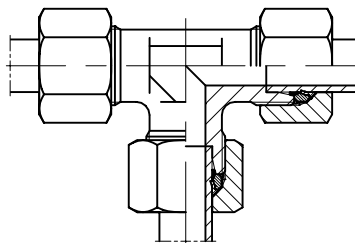

EO Fittings			Code	Price	Tube O.D. (mm)	PN (bar)	P max (bar)
<b>Extra Light Duty</b>							
HO117-1164	T04LLA3C	£4.56	4	100	250		
HO117-1165	T06LLA3C	£4.60	6	100	250		
HO117-1169	T08LLA3C	£5.31	8	100	250		
HO117-1172	T10LLA3C	£7.22	10	100	250		
HO117-1176	T12LLA3C	£8.13	12	100	250		
<b>Light Duty</b>							
HO117-1167	T06LA3C	£4.81	6	315	500		
HO117-1170	T08LA3C	£5.19	8	315	500		
HO117-1173	T10LA3C	£5.74	10	315	500		
HO117-1178	T12LA3C	£6.91	12	315	400		
HO117-1183	T15LA3C	£9.08	15	315	400		
HO117-1186	T18LA3C	£12.58	18	315	400		
HO117-1190	T22LA3C	£17.79	22	160	250		
HO117-1193	T28LA3C	£28.01	28	160	250		
HO117-1197	T35LA3C	£37.81	35	160	250		
HO117-1200	T42LA3C	£53.37	42	160	250		
<b>Heavy Duty</b>							
HO117-1168	T06SA3C	£5.49	6	630	900		
HO117-1171	T08SA3C	£6.01	8	630	900		
HO117-1174	T10SA3C	£6.94	10	630	900		
HO117-1179	T12SA3C	£7.63	12	630	900		
HO117-1181	T14SA3C	£13.69	14	630	700		
HO117-1184	T16SA3C	£12.97	16	400	630		
HO117-1187	T20SA3C	£20.37	20	400	500		
HO117-1191	T25SA3C	£29.80	25	400	500		
HO117-1194	T30SA3C	£38.67	30	400	420		
HO117-1198	T38SA3C	£57.65	38	315	420		

EO-2 Fittings			Code	Price
HO113-0566	T04ZLA3C	£7.00		
HO113-0565	T06ZLA3C	£7.33		
<b>EO-2 Fittings</b>				
HO113-0343	T06ZLA3C	£7.20		
HO113-0259	T08ZLA3C	£7.77		
HO113-0261	T10ZLA3C	£8.99		
HO113-0263	T12ZLA3C	£10.39		
HO113-0265	T15ZLA3C	£13.65		
HO113-0341	T18ZLA3C	£19.60		
HO113-0268	T22ZLA3C	£26.44		
HO113-0336	T28ZLA3C	£38.09		
HO113-0271	T35ZLA3C	£56.07		
HO113-0273	T42ZLA3C	£77.78		
HO113-0258	T06ZSA3C	£8.05		
HO113-0260	T08ZSA3C	£8.81		
HO113-0262	T10ZSA3C	£9.99		
HO113-0264	T12ZSA3C	£11.60		
HO113-0570	T14ZSA3C	£21.61		
HO113-0266	T16ZSA3C	£19.17		
HO113-0267	T20ZSA3C	£27.95		
HO113-0269	T25ZSA3C	£41.29		
HO113-0270	T30ZSA3C	£54.92		
HO113-0272	T38ZSA3C	£78.17		

### K Union Cross

All 4 ends EO tube end

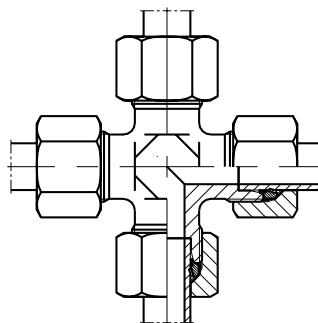

EO Fittings			Code	Price	Tube O.D. (mm)	PN (bar)	P max (bar)
<b>Extra Light Duty</b>							
HO117-0206	K04LLA3C	£17.65	4	100	250		
HO117-0828	K06LLA3C	£17.44	6	100	250		
HO117-0831	K08LLA3C	£18.19	8	100	250		
<b>Light Duty</b>							
HO117-0829	K06LA3C	£14.52	6	315	500		
HO117-0832	K08LA3C	£15.98	8	315	500		
HO117-0812	K10LA3C	£17.29	10	315	500		
HO117-0814	K12LA3C	£17.29	12	315	400		
HO117-0817	K15LA3C	£22.72	15	315	400		
HO117-0819	K18LA3C	£29.39	18	315	400		
HO117-0821	K22LA3C	£42.05	22	160	250		
HO117-0823	K28LA3C	£54.65	28	160	250		
HO117-0825	K35LA3C	£74.86	35	160	250		
HO117-0827	K42LA3C	£115.16	42	160	250		
<b>Heavy Duty</b>							
HO117-0830	K06SA3C	£17.39	6	630	900		
HO117-0833	K08SA3C	£18.89	8	630	900		
HO117-0813	K10SA3C	£20.38	10	630	900		
HO117-0815	K12SA3C	£21.61	12	630	900		
HO117-0816	K14SA3C	£32.18	14	400	630		
HO117-0818	K16SA3C	£31.53	16	400	630		
HO117-0820	K20SA3C	£45.52	20	315	400		
HO117-0822	K25SA3C	£54.69	25	315	400		
HO117-0824	K30SA3C	£73.88	30	315	400		
HO117-0826	K38SA3C	£116.84	38	315	400		

EO-2 Fittings			Code	Price
HO113-0760	K04ZLA3C	£20.55		
HO113-0761	K06ZLA3C	£20.72		
<b>EO-2 Fittings</b>				
HO113-0182	K06ZLA3C	£17.45		
HO113-0183	K08ZLA3C	£19.12		
HO113-0184	K10ZLA3C	£21.33		
HO113-0185	K12ZLA3C	£23.47		
HO113-0325	K15ZLA3C	£28.47		
HO113-0571	K18ZLA3C	£38.35		
HO113-0572	K22ZLA3C	£52.98		
HO113-0573	K28ZLA3C	£67.87		
HO113-0574	K35ZLA3C	£98.93		
HO113-0580	K42ZLA3C	£147.17		
HO113-0576	K06ZSA3C	£20.49		
HO113-0578	K08ZSA3C	£22.26		
HO113-0579	K10ZSA3C	£24.39		
HO113-0353	K12ZSA3C	£26.55		
HO113-0577	K14ZSA3C	£42.30		
HO113-0186	K16ZSA3C	£39.34		
HO113-0187	K20ZSA3C	£55.04		
HO113-0188	K25ZSA3C	£69.85		
HO113-0379	K30ZSA3C	£96.36		
HO113-0320	K38ZSA3C	£143.72		

= Manufacturer's code **EXAMPLE** = Special Price

Tube to Tube Unions

SECTION

40

Technical Helpline  
0845 120 9891

**Reducers**

**GR Straight Reducer**

EO tube end / EO tube end.

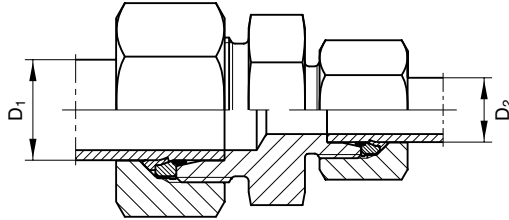

EO Fittings						EO-2 Fittings			
Code		Price	Tube O.D. (mm) D1	Tube O.D. (mm) D2	PN (bar)	P max (bar)	Code		Price
<b>Extra Light Duty</b>									
H0117-0783	GR06/04LLA3C	£3.79	6	4	100	250	H0113-0526	GR06/04ZLLA3C	£5.49
H0117-2697	GR08/04LLA3C	£12.27	8	4	100	250			
H0117-2696	GR08/06LLA3C	£12.54	8	6	100	250			
<b>Light Duty</b>									
H0117-0810	GR08/06LA3C	£3.29	8	6	315	500	H0113-0525	GR08/06ZLA3C	£4.94
H0117-0785	GR10/06LA3C	£3.61	10	6	315	500	H0113-0527	GR10/06ZLA3C	£5.49
H0117-0786	GR10/08LA3C	£3.73	10	8	315	500	H0113-0528	GR10/08ZLA3C	£5.67
H0117-0792	GR12/06LA3C	£4.08	12	6	315	400	H0113-0530	GR12/06ZLA3C	£6.04
H0117-0793	GR12/08LA3C	£4.18	12	8	315	400	H0113-0529	GR12/08ZLA3C	£6.18
H0117-0790	GR12/10LA3C	£4.29	12	10	315	400	H0113-0337	GR12/10ZLA3C	£6.53
H0117-0794	GR15/10LA3C	£5.34	15	10	315	400	H0113-0531	GR15/10ZLA3C	£7.94
H0117-0795	GR15/12LA3C	£5.48	15	12	315	400	H0113-0532	GR15/12ZLA3C	£8.16
H0117-1984	GR18/10LA3C	£7.41	18	10	315	400	H0113-0523	GR18/10ZLA3C	£10.79
H0117-1856	GR18/12LA3C	£7.49	18	12	315	400	H0113-0338	GR18/12ZLA3C	£10.95
H0117-0797	GR18/15LA3C	£7.83	18	15	315	400	H0113-0533	GR18/15ZLA3C	£11.67
H0117-1719	GR22/12LA3C	£11.96	22	12	160	250	H0113-0641	GR22/12ZLA3C	£15.88
H0117-0801	GR22/15LA3C	£9.79	22	15	160	250	H0113-0534	GR22/15ZLA3C	£14.17
H0117-2450	GR22/18LA3C	£10.55	22	18	160	250	H0113-0640	GR22/18ZLA3C	£15.76
H0117-2118	GR28/18LA3C	£19.28	28	18	160	250	H0113-0639	GR28/18ZLA3C	£25.25
H0117-0804	GR28/22LA3C	£19.46	28	22	160	250	H0113-0638	GR28/22ZLA3C	£26.02
H0117-0807	GR35/22LA3C	£25.61	35	22	160	250	H0113-0637	GR35/22ZLA3C	£34.96
H0117-0808	GR35/28LA3C	£27.60	35	28	160	250	H0113-0644	GR35/28ZLA3C	£37.40
H0117-2900	GR42/35LA3C	£39.65	42	35	160	250	H0113-0612	GR42/35ZLA3C	£54.37
<b>Heavy Duty</b>									
H0117-0811	GR08/06SA3C	£4.59	8	6	630	900	H0113-0619	GR08/06ZSA3C	£6.36
H0117-0784	GR10/06SA3C	£5.92	10	6	630	900	H0113-0613	GR10/06ZSA3C	£7.72
H0117-0787	GR10/08SA3C	£5.79	10	8	630	900	H0113-0618	GR10/08ZSA3C	£7.69
H0117-0788	GR12/06SA3C	£5.91	12	6	630	900	H0113-0588	GR12/06ZSA3C	£8.03
H0117-0789	GR12/08SA3C	£5.93	12	8	630	900	H0113-0621	GR12/08ZSA3C	£8.14
H0117-0791	GR12/10SA3C	£6.16	12	10	630	900	H0113-0622	GR12/10ZSA3C	£8.46
H0117-2698	GR16/10SA3C	£10.83	16	10	400	630	H0113-0615	GR16/10ZSA3C	£13.77
H0117-0796	GR16/12SA3C	£8.13	16	12	400	630	H0113-0623	GR16/12ZSA3C	£11.48
H0117-2695	GR16/14SA3C	£11.66	16	14	400	630	H0113-0624	GR16/14ZSA3C	£16.28
H0117-0798	GR20/10SA3C	£11.05	20	10	400	630	H0117-3129	GR20/10ZSA3C	£14.53
H0117-0799	GR20/12SA3C	£11.42	20	12	400	630	H0117-3126	GR20/12ZSA3C	£15.20
H0117-0800	GR20/16SA3C	£11.84	20	16	400	630	H0117-2569	GR20/16ZSA3C	£16.41
H0117-0802	GR25/16SA3C	£20.61	25	16	400	630	H0117-3128	GR25/16ZSA3C	£26.49
H0117-0803	GR25/20SA3C	£20.38	25	20	400	630	H0117-2611	GR25/20ZSA3C	£26.79
H0117-0805	GR30/20SA3C	£27.39	30	20	400	420	H0113-0469	GR30/20ZSA3C	£35.77
H0117-0806	GR30/25SA3C	£29.19	30	25	400	420	H0113-0616	GR30/25ZSA3C	£38.82
H0117-0809	GR38/30SA3C	£40.92	38	30	315	420	H0113-0468	GR38/30ZSA3C	£53.72

Reducers

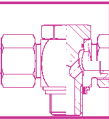

SECTION  
**40**

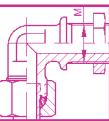

Online Order  
www.lister.co.uk

= Manufacturer's code **EXAMPLE** = Special Price



## Reducers



### TR Tee - Reducing

EO tube end all 3 ends

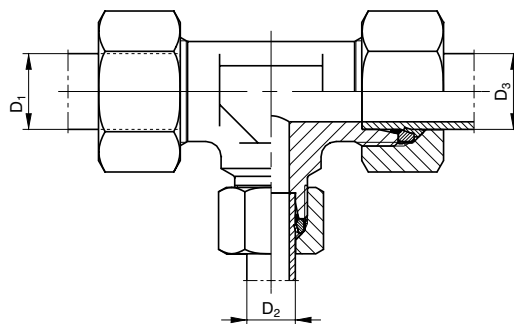

Reducers

Code	Tube O.D.(mm) D1	Tube O.D. (mm) D2	Tube O.D. (mm) D3	PN (bar)	P max (bar)	Price
<b>Extra Light Duty</b>						
H0117-2825	TR04/08/04LLA3C	4	8	4	100	250 <b>£33.53</b>
H0117-2824	TR06/04/06LLA3C	6	4	6	100	250 <b>£19.19</b>
<b>Light Duty</b>						
H0117-1229	TR06/08/06LA3C	6	8	6	315	500 <b>£14.21</b>
H0117-1230	TR08/06/08LA3C	8	6	8	315	500 <b>£9.27</b>
H0117-3013	TR06/10/06LA3C	6	10	6	315	500 <b>£22.75</b>
H0117-2823	TR08/10/08LA3C	8	10	8	315	500 <b>£18.29</b>
H0117-1233	TR10/06/10LA3C	10	6	10	315	500 <b>£10.85</b>
H0117-2411	TR10/08/10LA3C	10	8	10	315	500 <b>£13.98</b>
H0117-2822	TR10/10/06LA3C	10	10	6	315	500 <b>£15.72</b>
H0117-1231	TR08/12/08LA3C	8	12	8	315	400 <b>£16.42</b>
H0117-1235	TR12/06/12LA3C	12	6	12	315	400 <b>£12.49</b>
H0117-1236	TR12/08/08LA3C	12	8	8	315	400 <b>£16.80</b>
H0117-1237	TR12/08/12LA3C	12	8	12	315	400 <b>£12.18</b>
H0117-1238	TR12/10/10LA3C	12	10	10	315	400 <b>£18.40</b>
H0117-1239	TR12/10/12LA3C	12	10	12	315	400 <b>£12.35</b>
H0117-2826	TR12/12/10LA3C	12	12	10	315	400 <b>£29.27</b>
H0117-1232	TR10/15/10LA3C	10	15	10	315	400 <b>£23.51</b>
H0117-2010	TR12/15/12LA3C	12	15	12	315	400 <b>£19.47</b>
H0117-2827	TR15/06/15LA3C	15	6	15	315	400 <b>£29.12</b>
H0117-1244	TR15/10/15LA3C	15	10	15	315	400 <b>£20.56</b>
H0117-1245	TR15/12/12LA3C	15	12	12	315	400 <b>£19.81</b>
H0117-1246	TR15/12/15LA3C	15	12	15	315	400 <b>£18.14</b>
H0117-2828	TR15/15/12LA3C	15	15	12	315	400 <b>£16.82</b>
H0117-1242	TR12/18/12LA3C	12	18	12	315	400 <b>£33.14</b>
H0117-1249	TR18/10/10LA3C	18	10	10	315	400 <b>£41.98</b>
H0117-1250	TR18/10/18LA3C	18	10	18	315	400 <b>£24.68</b>
H0117-1251	TR18/12/18LA3C	18	12	18	315	400 <b>£25.19</b>
H0117-2830	TR18/15/18LA3C	18	15	18	315	400 <b>£26.15</b>
H0117-2829	TR18/18/10LA3C	18	18	10	315	400 <b>£29.60</b>
H0117-2489	TR22/10/22LA3C	22	10	22	160	250 <b>£47.60</b>

Code	Tube O.D.(mm) D1	Tube O.D. (mm) D2	Tube O.D. (mm) D3	PN (bar)	P max (bar)	Price
<b>Light Duty</b>						
H0117-1255	TR22/12/22LA3C	22	12	22	160	250 <b>£33.71</b>
H0117-1256	TR22/15/15LA3C	22	15	15	160	250 <b>£48.11</b>
H0117-1257	TR22/15/22LA3C	22	15	22	160	250 <b>£32.57</b>
H0117-2831	TR22/18/18LA3C	22	18	18	160	250 <b>£43.32</b>
H0117-1258	TR22/18/22LA3C	22	18	22	160	250 <b>£38.08</b>
H0117-2832	TR22/22/18LA3C	22	22	18	160	250 <b>£36.72</b>
H0117-1261	TR28/10/28LA3C	28	10	28	160	250 <b>£70.04</b>
H0117-2484	TR28/12/28LA3C	28	12	28	160	250 <b>£47.05</b>
H0117-1262	TR28/15/28LA3C	28	15	28	160	250 <b>£53.87</b>
H0117-2833	TR28/18/28LA3C	28	18	28	160	250 <b>£61.27</b>
H0117-2835	TR28/22/22LA3C	28	22	22	160	250 <b>£70.68</b>
H0117-2834	TR28/22/28LA3C	28	22	28	160	250 <b>£51.96</b>
<b>Heavy Duty</b>						
H0117-1234	TR10/06/10SA3C	10	6	10	630	900 <b>£21.16</b>
H0117-2837	TR12/08/08SA3C	12	8	8	630	900 <b>£22.33</b>
H0117-2836	TR12/08/12SA3C	12	8	12	630	900 <b>£27.97</b>
H0117-1240	TR12/10/12SA3C	12	10	12	630	900 <b>£30.72</b>
H0117-1241	TR12/16/12SA3C	12	16	12	400	630 <b>£26.56</b>
H0117-1247	TR16/06/16SA3C	16	6	16	400	630 <b>£38.23</b>
H0117-2838	TR16/08/16SA3C	16	8	16	400	630 <b>£28.46</b>
H0117-1248	TR16/10/16SA3C	16	10	16	400	630 <b>£24.06</b>
H0117-2017	TR16/12/16SA3C	16	12	16	400	630 <b>£26.18</b>
H0117-1857	TR16/20/16SA3C	16	20	16	400	630 <b>£42.35</b>
H0117-2428	TR20/10/20SA3C	20	10	20	400	630 <b>£58.58</b>
H0117-1252	TR20/12/20SA3C	20	12	20	400	630 <b>£58.65</b>
H0117-1253	TR20/16/20SA3C	20	16	20	400	630 <b>£45.08</b>
H0117-1254	TR20/25/20SA3C	20	25	20	400	630 <b>£56.36</b>
H0117-1259	TR25/16/25SA3C	25	16	25	400	630 <b>£50.68</b>
H0117-1260	TR25/20/25SA3C	25	20	25	400	630 <b>£55.17</b>
H0117-2144	TR25/30/25SA3C	25	30	25	400	420 <b>£170.55</b>

SECTION

40

Technical Helpline  
0845 120 9891

= Manufacturer's code **EXAMPLE** = Special Price

**Bulkheads**

**SV Bulkhead Union**

EO tube end / EO tube end

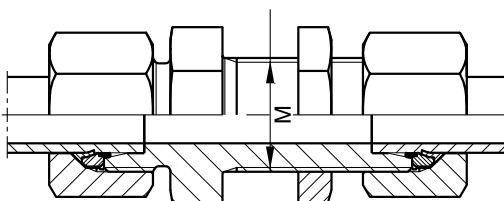

EO Fittings							EO-2 Fittings				
Code		Price	Tube O.D. (mm)	Locknut Thread M	Locknut Ref	PN (bar)	P max (bar)	Code		Price	
<b>Light Duty</b>											
HO117-1131	SV06LA3C	£3.01	6	m12 x 1.5	GM 06-L	315	500	HO113-0241	SV06ZLA3C	£4.61	
HO117-1134	SV08LA3C	£3.11	8	m14 x 1.5	GM 08-L	315	500	HO113-0242	SV08ZLA3C	£4.84	
HO117-1107	SV10LA3C	£3.86	10	m16 x 1.5	GM 10-L	315	500	HO113-0243	SV10ZLA3C	£6.02	
HO117-1111	SV12LA3C	£4.43	12	m18 x 1.5	GM 12-L	315	400	HO113-0245	SV12ZLA3C	£6.75	
HO117-1116	SV15LA3C	£6.72	15	m22 x 1.5	GM 15-L	315	400	HO113-0247	SV15ZLA3C	£9.74	
HO117-1119	SV18LA3C	£10.80	18	m26 x 1.5	GM 18-L	315	400	HO113-0249	SV18ZLA3C	£15.40	
HO117-1121	SV22LA3C	£13.82	22	m30 x 2	GM 22-L	160	250	HO113-0251	SV22ZLA3C	£19.51	
HO117-1123	SV28LA3C	£20.50	28	m36 x 2	GM 28-L	160	250	HO113-0390	SV28ZLA3C	£27.20	
HO117-1127	SV35LA3C	£31.35	35	m45 x 2	GM 35-L	160	250	HO113-0524	SV35ZLA3C	£43.46	
HO117-1130	SV42LA3C	£42.01	42	m52 x 2	GM 42-L	160	250	HO113-0255	SV42ZLA3C	£58.20	
<b>Heavy Duty</b>											
HO117-1132	SV06SA3C	£3.46	6	m14 x 1.5	GM 08-L	630	900	HO113-0256	SV06ZSA3C	£5.18	
HO117-1135	SV08SA3C	£4.30	8	m16 x 1.5	GM 08-S	630	900	HO113-0352	SV08ZSA3C	£6.16	
HO117-1108	SV10SA3C	£4.99	10	m18 x 1.5	GM 10-S	630	900	HO113-0244	SV10ZSA3C	£7.01	
HO117-1112	SV12SA3C	£6.62	12	m20 x 1.5	GM 12-S	630	900	HO113-0246	SV12ZSA3C	£9.22	
HO117-1114	SV14SA3C	£10.99	14	m22 x 1.5	GM 14-S	630	700	HO113-0586	SV14ZSA3C	£18.20	
HO117-1117	SV16SA3C	£10.89	16	m24 x 1.5	GM 16-S	400	630	HO113-0248	SV16ZSA3C	£14.96	
HO117-1120	SV20SA3C	£16.77	20	m30 x 2	GM 20-S	400	630	HO113-0250	SV20ZSA3C	£21.72	
HO117-1122	SV25SA3C	£26.10	25	m36 x 2	GM 25-S	400	630	HO113-0252	SV25ZSA3C	£33.69	
HO117-1124	SV30SA3C	£32.01	30	m42 x 2	GM 30-S	400	420	HO113-0253	SV30ZSA3C	£42.77	
HO117-1128	SV38SA3C	£51.58	38	m52 x 2	GM 38-S	315	420	HO113-0254	SV38ZSA3C	£65.11	

**WSV Bulkhead Elbow**

EO tube end / EO tube end

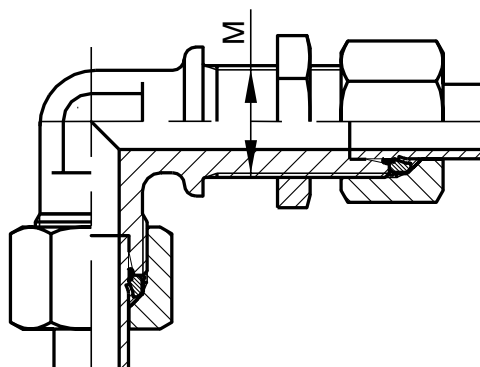

EO Fittings							EO-2 Fittings				
Code		Price	Tube O.D. (mm)	Male Thread M	Locknut ref	PN (bar)	P max (bar)	Code		Price	
<b>Light Duty</b>											
HO117-1494	WSV06LA3C	£6.00	6	m12 x 1.5	GM 06-L	315	500	HO113-0310	WSV06ZLA3C	£7.51	
HO117-1497	WSV08LA3C	£6.23	8	m14 x 1.5	GM 08-L	315	500	HO113-0312	WSV08ZLA3C	£7.86	
HO117-1475	WSV10LA3C	£6.93	10	m16 x 1.5	GM 10-L	315	500	HO113-0313	WSV10ZLA3C	£9.01	
HO117-1477	WSV12LA3C	£8.48	12	m18 x 1.5	GM 12-L	315	400	HO113-0314	WSV12ZLA3C	£10.68	
HO117-1481	WSV15LA3C	£10.08	15	m22 x 1.5	GM 15-L	315	400	HO113-0316	WSV15ZLA3C	£13.00	
HO117-1484	WSV18LA3C	£14.38	18	m26 x 1.5	GM 18-L	315	400	HO113-0466	WSV18ZLA3C	£18.87	
HO117-1486	WSV22LA3C	£22.51	22	m30 x 2	GM 22-L	160	250	HO113-0318	WSV22ZLA3C	£27.94	
HO117-1488	WSV28LA3C	£33.68	28	m36 x 2	GM 28-L	160	250	HO113-0465	WSV28ZLA3C	£40.21	
HO117-1490	WSV35LA3C	£49.44	35	m45 x 2	GM 35-L	160	250	HO113-0481	WSV35ZLA3C	£61.33	
HO117-1492	WSV42LA3C	£70.12	42	m52 x 2	GM 42-L	160	250	HO113-0480	WSV42ZLA3C	£85.97	
<b>Heavy Duty</b>											
HO117-1495	WSV06SA3C	£6.90	6	m14 x 1.5	GM 08-L	630	900	HO113-0311	WSV06ZSA3C	£8.51	
HO117-1498	WSV08SA3C	£7.65	8	m16 x 1.5	GM 08-S	630	900	HO113-0370	WSV08ZSA3C	£9.39	
HO117-1476	WSV10SA3C	£9.55	10	m18 x 1.5	GM 10-S	630	900	HO113-0371	WSV10ZSA3C	£11.42	
HO117-1478	WSV12SA3C	£9.86	12	m20 x 1.5	GM 12-S	630	900	HO113-0315	WSV12ZSA3C	£12.37	
HO117-1479	WSV14SA3C	£15.53	14	m22 x 1.5	GM 14-S	630	700	HO113-0620	WSV14ZSA3C	£20.61	
HO117-1482	WSV16SA3C	£14.30	16	m24 x 1.5	GM 16-S	400	630	HO113-0317	WSV16ZSA3C	£18.25	
HO117-1485	WSV20SA3C	£22.44	20	m30 x 2	GM 20-S	400	630	HO113-0414	WSV20ZSA3C	£27.21	
HO117-1487	WSV25SA3C	£35.50	25	m36 x 2	GM 25-S	400	630	HO113-0319	WSV25ZSA3C	£43.36	
HO117-1489	WSV30SA3C	£49.05	30	m42 x 2	GM 30-S	400	420	HO113-0372	WSV30ZSA3C	£58.63	
HO117-1491	WSV38SA3C	£72.87	38	m52 x 2	GM 38-S	315	420	HO113-0373	WSV38ZSA3C	£87.11	

= Manufacturer's code **EXAMPLE** = Special Price

Bulkheads

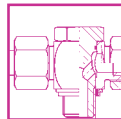

SECTION  
**40**

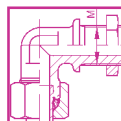

Online Order  
www.lister.co.uk

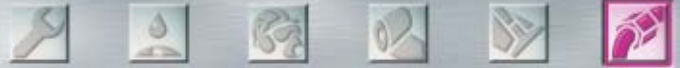

## Tube to Swivel O-ring Seal



### Swivel Nut Fittings



The Parker EO range of swivel nut fittings is designed to meet the practical demands of simplified assembly, as well as functional and operational reliability even under difficult conditions. This fitting range should be preferred for new designs instead of preassembled standpipe fittings.

Assembly: Insert the swivel nut in the 24° cone of the fitting body, initially tighten the nut by hand then, using a spanner tighten a further 1/4 to 1/2 turns (we recommend lubricating the O-ring first).

#### Advantages:

- Can be used with all standard fitting bodies with 24° cones (port type W DIN 3861)
- Swivel nut connection conforms to DIN 3865
- Simplified assembly and shorter assembly times due to reduced tightening distances with low assembly forces
- Increased functional reliability and leak-proof by O-ring seal
- High pressure tear out resistance
- Interchangeable with standard adjustable pre-assembled standpipe fittings.

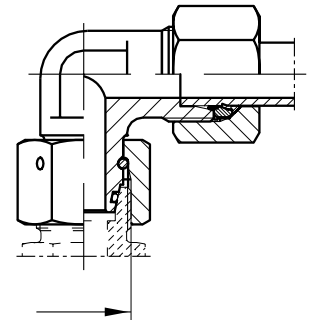

Tube to Swivel O-ring Seal

### EW Swivel Nut Elbow

EO tube end / EO Swivel

#### EO Fittings

Code	Price	Tube O.D. (mm)	Female Thread (d1)	PN (bar)	P max (bar)
<b>Light Duty</b>					
HO117-0400	£4.56	6	m12 x 1.5	315	500
HO117-0404	£4.58	8	m14 x 1.5	315	500
HO117-0409	£5.02	10	m16 x 1.5	315	500
HO117-0412	£6.86	12	m18 x 1.5	315	400
HO117-0418	£7.11	15	m22 x 1.5	315	400
HO117-0422	£10.19	18	m26 x 1.5	315	400
HO117-0427	£13.93	22	m30 x 2	160	250
HO117-0430	£20.81	28	m36 x 2	160	250
HO117-0434	£30.57	35	m45 x 2	160	250
HO117-2127	£43.86	42	m52 x 2	160	250
<b>Heavy Duty</b>					
HO117-0401	£5.12	6	m14 x 1.5	630	900
HO117-0405	£5.71	8	m16 x 1.5	630	900
HO117-0410	£6.46	10	m18 x 1.5	630	900
HO117-0414	£6.81	12	m20 x 1.5	630	900
HO117-0416	£9.75	14	m22 x 1.5	630	700
HO117-0419	£10.52	16	m24 x 1.5	400	630
HO117-0424	£15.01	20	m30 x 2	400	630
HO117-0428	£22.16	25	m36 x 2	400	630
HO117-0431	£31.08	30	m42 x 2	400	420
HO117-0435	£46.45	38	m52 x 2	315	420

#### EO-2 Fittings

Code	Price
HO113-0063	£5.26
HO113-0065	£5.35
HO113-0067	£6.01
HO113-0069	£7.87
HO113-0071	£8.50
HO113-0073	£12.34
HO113-0075	£16.55
HO113-0077	£24.30
HO113-0079	£36.85
HO113-0081	£52.26
HO113-0064	£5.87
HO113-0066	£6.52
HO113-0068	£7.34
HO113-0070	£8.00
HO113-0611	£12.22
HO113-0072	£12.39
HO113-0074	£17.27
HO113-0076	£25.85
HO113-0078	£36.28
HO113-0080	£52.97

### EV Swivel Nut 45° Elbow

EO tube end / EO Swivel

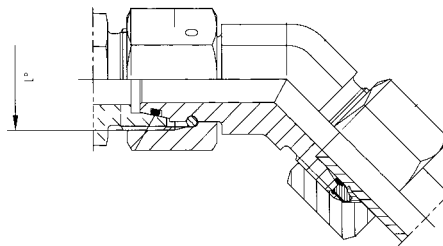

#### EO Fittings

Code	Price	Tube O.D. (mm)	Female Thread (d1)
<b>Light Duty</b>			
HO117-2165	£15.88	6	m12 x 1.5
HO117-1974	£15.99	8	m14 x 1.5
HO117-1968	£16.44	10	m16 x 1.5
HO117-1967	£17.87	12	m18 x 1.5
HO117-1629	£18.57	15	m22 x 1.5
HO117-1573	£21.17	18	m26 x 1.5
HO117-1577	£26.45	22	m30 x 2
HO117-1576	£32.26	28	m36 x 2
HO117-1575	£57.51	35	m45 x 2
HO117-1574	£61.87	42	m52 x 2
<b>Heavy Duty</b>			
HO117-1572	£19.62	6	m14 x 1.5
HO117-1578	£19.69	8	m16 x 1.5
HO117-1581	£19.95	10	m18 x 1.5
HO117-1580	£20.10	12	m20 x 1.5
HO117-1595	£21.62	16	m24 x 1.5
HO117-1596	£28.14	20	m30 x 2
HO117-1606	£33.89	25	m36 x 2
HO117-1923	£58.74	30	m42 x 2
HO117-1973	£65.96	38	m52 x 2

#### EO-2 Fittings

Code	Price
HO113-0416	£16.21
HO113-0417	£16.39
HO117-1858	£17.05
HO117-2253	£18.53
HO117-2254	£19.60
HO117-2255	£22.97
HO117-2256	£28.67
HO117-2257	£35.74
HO117-2258	£63.77
HO117-2259	£70.25
HO113-0362	£19.89
HO113-0361	£20.05
HO117-1868	£20.39
HO117-2252	£20.87
HO117-2260	£23.13
HO117-2261	£29.99
HO117-2262	£37.84
HO117-2263	£64.30
HO117-2264	£73.04

☰ = Manufacturer's code **EXAMPLE** = Special Price

SECTION  
40

Technical Helpline  
0845 120 9891



**Tube to Swivel O-ring Seal**

**ET Swivel Nut Branch Tee**

EO tube ends / EO Swivel

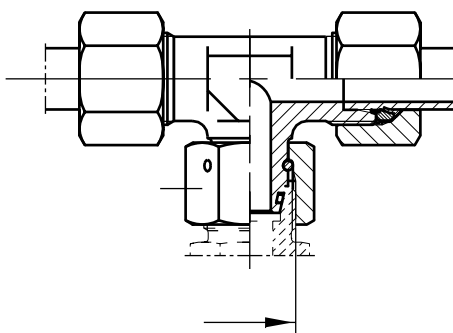

EO Fittings						EO-2 Fittings			
Code		Price	Tube O.D. (mm)	Female Thread (d1)	PN (bar)	P max (bar)	Code		Price
<b>Light Duty</b>									
HO117-0294	ET06LA3C	£7.17	6	m12 x 1.5	315	500	HO113-0049	ET06ZLA3C	£8.64
HO117-0297	ET08LA3C	£7.49	8	m14 x 1.5	315	500	HO113-0051	ET08ZLA3C	£9.08
HO117-0299	ET10LA3C	£8.48	10	m16 x 1.5	315	500	HO113-0342	ET10ZLA3C	£10.50
HO117-0301	ET12LA3C	£8.84	12	m18 x 1.5	315	400	HO113-0054	ET12ZLA3C	£11.02
HO117-0303	ET15LA3C	£11.60	15	m22 x 1.5	315	400	HO113-0056	ET15ZLA3C	£14.47
HO117-0308	ET18LA3C	£15.70	18	m26 x 1.5	315	400	HO113-0614	ET18ZLA3C	£20.14
HO117-0310	ET22LA3C	£24.25	22	m30 x 2	160	250	HO113-0471	ET22ZLA3C	£29.62
HO117-0313	ET28LA3C	£34.90	28	m36 x 2	160	250	HO113-0482	ET28ZLA3C	£41.42
HO117-0315	ET35LA3C	£46.24	35	m45 x 2	160	250	HO113-0483	ET35ZLA3C	£58.17
HO117-0318	ET42LA3C	£69.96	42	m52 x 2	160	250	HO113-0062	ET42ZLA3C	£86.77
<b>Heavy Duty</b>									
HO117-0295	ET06SA3C	£8.20	6	m14 x 1.5	630	900	HO113-0050	ET06ZSA3C	£9.76
HO117-0298	ET08SA3C	£9.01	8	m16 x 1.5	630	900	HO113-0052	ET08ZSA3C	£10.71
HO117-0300	ET10SA3C	£9.99	10	m18 x 1.5	630	900	HO113-0053	ET10ZSA3C	£11.85
HO117-0302	ET12SA3C	£11.26	12	m20 x 1.5	630	900	HO113-0055	ET12ZSA3C	£13.71
HO117-2126	ET14SA3C	£32.98	14	m22 x 1.5	630	700	HO113-0610	ET14ZSA3C	£43.19
HO117-0305	ET16SA3C	£16.42	16	m24 x 1.5	400	630	HO113-0057	ET16ZSA3C	£20.30
HO117-0309	ET20SA3C	£25.81	20	m30 x 2	400	630	HO113-0058	ET20ZSA3C	£30.47
HO117-0311	ET25SA3C	£37.33	25	m36 x 2	400	630	HO113-0059	ET25ZSA3C	£44.79
HO117-0314	ET30SA3C	£47.39	30	m42 x 2	400	420	HO113-0060	ET30ZSA3C	£58.63
HO117-0316	ET38SA3C	£75.33	38	m52 x 2	315	420	HO113-0061	ET38ZSA3C	£89.55

**EL Swivel Nut Run Tee**

EO tube ends / EO Swivel

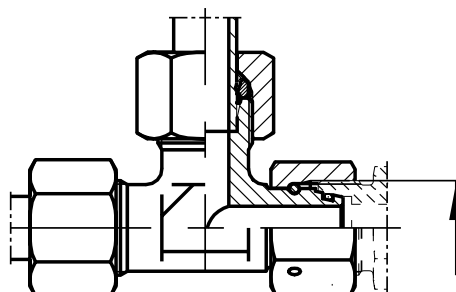

EO Fittings						EO-2 Fittings			
Code		Price	Tube O.D. (mm)	Female Thread (d1)	PN (bar)	P max (bar)	Code		Price
<b>Light Duty</b>									
HO117-0223	EL06LA3C	£7.37	6	m12 x 1.5	315	500	HO113-0030	EL06ZLA3C	£8.83
HO117-0226	EL08LA3C	£7.56	8	m14 x 1.5	315	500	HO113-0032	EL08ZLA3C	£9.15
HO117-0228	EL10LA3C	£8.30	10	m16 x 1.5	315	500	HO113-0034	EL10ZLA3C	£10.32
HO117-0232	EL12LA3C	£9.30	12	m18 x 1.5	315	400	HO113-0036	EL12ZLA3C	£11.47
HO117-0237	EL15LA3C	£12.09	15	m22 x 1.5	315	400	HO113-0646	EL15ZLA3C	£14.94
HO117-0242	EL18LA3C	£16.47	18	m26 x 1.5	315	400	HO113-0604	EL18ZLA3C	£20.90
HO117-0247	EL22LA3C	£24.06	22	m30 x 2	160	250	HO113-0645	EL22ZLA3C	£29.43
HO117-0252	EL28LA3C	£35.22	28	m36 x 2	160	250	HO113-0617	EL28ZLA3C	£41.75
HO117-0256	EL35LA3C	£47.06	35	m45 x 2	160	250	HO113-0647	EL35ZLA3C	£58.98
HO117-0260	EL42LA3C	£70.91	42	m52 x 2	160	250	HO113-0625	EL42ZLA3C	£86.75
<b>Heavy Duty</b>									
HO117-0224	EL06SA3C	£8.33	6	m14 x 1.5	630	900	HO113-0031	EL06ZSA3C	£9.90
HO117-0227	EL08SA3C	£8.30	8	m16 x 1.5	630	900	HO113-0033	EL08ZSA3C	£10.02
HO117-0229	EL10SA3C	£10.31	10	m18 x 1.5	630	900	HO113-0035	EL10ZSA3C	£12.15
HO117-0234	EL12SA3C	£11.36	12	m20 x 1.5	630	900	HO113-0037	EL12ZSA3C	£13.82
HO117-0235	EL14SA3C	£17.48	14	m22 x 1.5	630	700	HO113-0648	EL14ZSA3C	£22.50
HO117-0238	EL16SA3C	£17.93	16	m24 x 1.5	400	630	HO113-0038	EL16ZSA3C	£21.78
HO117-0244	EL20SA3C	£25.67	20	m30 x 2	400	630	HO113-0039	EL20ZSA3C	£30.34
HO117-0248	EL25SA3C	£37.61	25	m36 x 2	400	630	HO113-0040	EL25ZSA3C	£45.06
HO117-0253	EL30SA3C	£48.33	30	m42 x 2	400	420	HO113-0041	EL30ZSA3C	£59.56
HO117-0257	EL38SA3C	£77.14	38	m52 x 2	315	420	HO113-0042	EL38ZSA3C	£90.36

= Manufacturer's code **EXAMPLE** = Special Price

Tube to Swivel O-ring seal

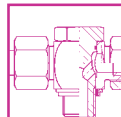

SECTION  
40

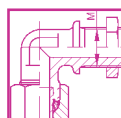

Online order  
www.lister.co.uk



## Swivel to Swivel



### GZ Swivel Union

EO Swivel / EO Swivel

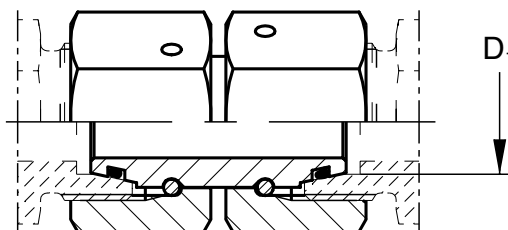

Swivel to Swivel

#### EO Fittings

Code		Price	Tube O.D. (mm) D1	PN (bar)	P max (bar)
<b>Light Duty</b>					
HO117-1640	GZ06LA3G	£6.38	6	315	500
HO117-1641	GZ08LA3G	£6.87	8	315	500
HO117-1636	GZ10LA3G	£7.11	10	315	500
HO117-1502	GZ12LA3G	£7.63	12	315	400
HO117-1642	GZ15LA3G	£8.54	15	315	400
HO117-2294	GZ18LA3G	£9.40	18	315	400
HO117-1976	GZ22LA3G	£10.72	22	160	250
HO117-2046	GZ28LA3G	£15.93	28	160	250
HO117-2371	GZ35LA3G	£18.49	35	160	250
HO117-2635	GZ42LA3G	£22.43	42	160	250
<b>Heavy Duty</b>					
HO117-1977	GZ06SA3G	£7.55	6	630	900
HO117-1978	GZ08SA3G	£8.09	8	630	900
HO117-1979	GZ10SA3G	£8.29	10	630	900
HO117-1980	GZ12SA3G	£9.09	12	630	900
HO117-2636	GZ14SA3G	£11.24	14	630	700
HO117-1503	GZ16SA3G	£10.74	16	400	630
HO117-1959	GZ20SA3G	£12.31	20	400	630
HO117-1981	GZ25SA3G	£15.60	25	400	630
HO117-1702	GZ30SA3G	£22.82	30	400	420
HO117-1962	GZ38SA3G	£25.62	38	315	420

#### EO-2 Fittings

Code		Price
HO117-1640	GZ06LA3C	£6.38
HO117-1641	GZ08LA3C	£6.87
HO117-1636	GZ10LA3C	£7.11
HO117-1502	GZ12LA3C	£7.63
HO117-1642	GZ15LA3C	£8.54
HO117-2294	GZ18LA3C	£9.40
HO117-1976	GZ22LA3C	£10.72
HO117-2046	GZ28LA3C	£15.93
HO117-2371	GZ35LA3C	£18.49
HO117-2635	GZ42LA3C	£22.43
HO117-1977	GZ06SA3C	£7.55
HO117-1978	GZ08SA3C	£8.09
HO117-1979	GZ10SA3C	£8.29
HO117-1980	GZ12SA3C	£9.09
HO117-2636	GZ14SA3C	£11.24
HO117-1503	GZ16SA3C	£10.74
HO117-1959	GZ20SA3C	£12.31
HO117-1981	GZ25SA3C	£15.60
HO117-1702	GZ30SA3C	£22.82
HO117-1962	GZ38SA3C	£25.62

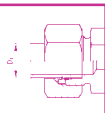

SECTION  
**40**



Technical Helpline  
**0845 120 9891**

## Hose Doctor



Hydraulic Hose Replacement Service

**Unit 33  
Springvale Ind. Estate  
Millfields Road  
Bilston  
West Midlands  
WV14 0QL**

with you within 1 hour  
**0800 0560307**  
gets YOU back  
in business



A division of James Lister & Sons Ltd.

 = Manufacturer's code **EXAMPLE** = Special Price

**Swivel to Swivel**

**GZR Swivel Reducer**

EO Swivel / EO Swivel

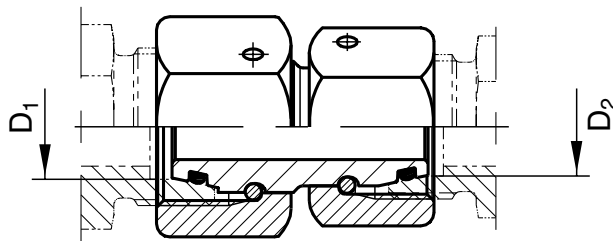

EO Fittings						EO-2 Fittings		
Code	Price	Tube O.D. (mm) D1	Tube O.D. (mm) D2	PN (bar)	P max (bar)	Code	Price	
<b>Light Duty</b>								
H0117-2669	£9.51	8	6	315	500	H0117-2669	£9.51	
H0117-2662	£11.50	10	6	315	500	H0117-2662	£11.50	
H0117-2663	£9.68	10	8	315	500	H0117-2663	£9.68	
H0117-2670	£12.00	12	6	315	400	H0117-2670	£12.00	
H0117-2671	£11.13	12	8	315	400	H0117-2671	£11.13	
H0117-2666	£9.81	12	10	315	400	H0117-2666	£9.81	
H0117-2661	£13.78	15	8	315	400	H0117-2661	£13.78	
H0117-2664	£13.02	15	10	315	400	H0117-2664	£13.02	
H0117-2854	£11.72	15	12	315	400	H0117-2854	£11.72	
H0117-2853	£15.11	18	10	315	400	H0117-2853	£15.11	
H0117-2852	£13.92	18	12	315	400	H0117-2852	£13.92	
H0117-2851	£12.35	18	15	315	400	H0117-2851	£12.35	
H0117-2848	£17.84	22	12	160	250	H0117-2848	£17.84	
H0117-2849	£16.45	22	15	160	250	H0117-2849	£16.45	
H0117-2850	£14.96	22	18	160	250	H0117-2850	£14.96	
H0117-2855	£20.21	28	15	160	250	H0117-2855	£20.21	
H0117-2356	£18.90	28	18	160	250	H0117-2356	£18.90	
H0117-2856	£16.90	28	22	160	250	H0117-2856	£16.90	
H0117-2858	£27.19	35	18	160	250	H0117-2858	£27.19	
H0117-2857	£26.02	35	22	160	250	H0117-2857	£26.02	
H0117-2859	£24.61	35	28	160	250	H0117-2859	£24.61	
H0117-2861	£32.70	42	22	160	250	H0117-2861	£32.70	
H0117-2860	£32.27	42	28	160	250	H0117-2860	£32.27	
H0117-2862	£31.50	42	35	160	250	H0117-2862	£31.50	
<b>Light / Heavy Duty</b>								
H0117-2660	£13.05	6	6	315	500	H0117-2660	£13.05	
H0117-2366	£13.80	8	8	315	500	H0117-2366	£13.80	
H0117-2097	£14.60	10	10	315	500	H0117-2097	£14.60	
H0117-2341	£15.24	12	12	315	400	H0117-2341	£15.24	
H0117-2337	£16.34	18	16	315	400	H0117-2337	£16.34	
H0117-1816	£18.39	22	20	160	250	H0117-1816	£18.39	
H0117-2651	£23.98	28	25	160	250	H0117-2651	£23.98	
H0117-2656	£33.50	35	30	160	250	H0117-2656	£33.50	
H0117-2657	£40.94	42	38	160	250	H0117-2657	£40.94	
<b>Heavy Duty</b>								
H0117-2640	£11.99	8	6	630	900	H0117-2640	£11.99	
H0117-2645	£13.98	10	6	630	900	H0117-2645	£13.98	
H0117-2633	£12.16	10	8	630	900	H0117-2633	£12.16	
H0117-2641	£14.01	12	8	630	900	H0117-2641	£14.01	
H0117-2643	£12.73	12	10	630	900	H0117-2643	£12.73	
H0117-2642	£15.64	16	10	400	900	H0117-2642	£15.64	
H0117-2648	£14.57	16	12	400	900	H0117-2648	£14.57	
H0117-2630	£16.52	20	12	400	630	H0117-2630	£16.52	
H0117-2631	£15.31	20	16	400	630	H0117-2631	£15.31	
H0117-2037	£18.06	25	16	400	630	H0117-2037	£18.06	
H0117-2036	£16.37	25	20	400	630	H0117-2036	£16.37	
H0117-2647	£26.65	30	16	400	420	H0117-2647	£26.65	
H0117-2646	£25.47	30	20	400	420	H0117-2646	£25.47	
H0117-2075	£23.26	30	25	400	420	H0117-2075	£23.26	
H0117-2637	£34.84	38	20	315	420	H0117-2637	£34.84	
H0117-2655	£33.91	38	25	315	420	H0117-2655	£33.91	
H0117-2634	£32.43	38	30	315	420	H0117-2634	£32.43	
<b>Heavy / Light Duty</b>								
H0117-2349	£15.61	16	15	315	400	H0117-2349	£15.61	
H0117-2099	£17.11	20	18	315	400	H0117-2099	£17.11	
H0117-2039	£21.98	25	22	160	250	H0117-2039	£21.98	
H0117-2639	£31.50	30	28	160	250	H0117-2639	£31.50	
H0117-2632	£39.63	38	35	160	250	H0117-2632	£39.63	

⚙️ = Manufacturer's code **EXAMPLE** = Special Price

Swivel to Swivel

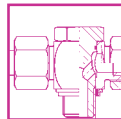

SECTION  
**40**

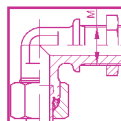

Online Order  
[www.lister.co.uk](http://www.lister.co.uk)



## Tube End Reducers



### RED Tube End Reducer

EO Swivel / EO tube end.

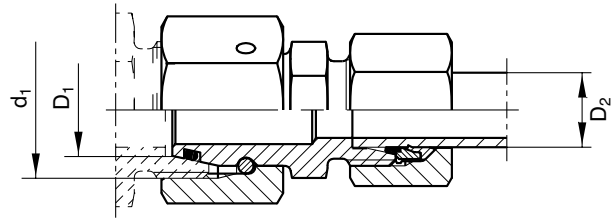

Tube End Reducers

EO Fittings							EO-2 Fittings			
Code	Image	Price	Tube O.D. (mm) D1	Tube O.D.(mm) D2	Female Thread d1	PN (bar)	P max (bar)	Code	Image	Price
<b>Light / Extra Light Series</b>										
H0117-2784		£3.42	6	4	m12 x 1.5	100	250	RED06L/04ZLA3C		£
<b>Light Series</b>										
H0117-0974		£3.01	8	6	m14 x 1.5	315	500	H0113-0194		£3.76
H0117-0978		£3.14	10	6	m16 x 1.5	315	500	H0113-0195		£3.89
H0117-0976		£3.18	10	8	m16 x 1.5	315	500	H0113-0196		£4.00
H0117-0981		£3.33	12	6	m18 x 1.5	315	400	H0113-0198		£4.07
H0117-0983		£3.37	12	8	m18 x 1.5	315	400	H0113-0200		£4.18
H0117-0985		£3.44	12	10	m18 x 1.5	315	400	H0113-0201		£4.48
H0117-0987		£3.88	15	6	m22 x 1.5	315	400	H0113-0202		£4.60
H0117-0988		£3.75	15	8	m22 x 1.5	315	400	H0113-0350		£4.54
H0117-0989		£3.81	15	10	m22 x 1.5	315	400	H0113-0203		£4.84
H0117-0990		£3.94	15	12	m22 x 1.5	315	400	H0113-0204		£5.05
H0117-0995		£7.72	18	6	m26 x 1.5	315	400	H0113-0609		£8.32
H0117-0996		£4.84	18	8	m26 x 1.5	315	400	H0113-0650		£5.60
H0117-0998		£4.86	18	10	m26 x 1.5	315	400	H0117-1949		£5.84
H0117-1000		£4.99	18	12	m26 x 1.5	315	400	H0113-0209		£6.06
H0117-1001		£5.23	18	15	m26 x 1.5	315	400	H0113-0334		£6.68
H0117-1008		£9.91	22	6	m30 x 2	160	250	H0117-0666		£10.52
H0117-1009		£8.94	22	8	m30 x 2	160	250	H0117-0668		£9.56
H0117-1010		£8.37	22	10	m30 x 2	160	250	H0113-0412		£9.25
H0117-1012		£6.25	22	12	m30 x 2	160	250	H0113-0214		£7.28
H0117-1013		£6.49	22	15	m30 x 2	160	250	H0117-2293		£7.91
H0117-2019		£7.17	22	18	m30 x 2	160	250	H0117-1600		£9.41
H0117-1023		£14.85	28	6	m36 x 2	160	250	H0113-0428		£15.51
H0117-1024		£14.09	28	8	m36 x 2	160	250	H0113-0359		£14.83
H0117-1026		£11.72	28	10	m36 x 2	160	250	H0113-0424		£12.71
H0117-1027		£10.92	28	12	m36 x 2	160	250	H0113-0605		£12.00
H0117-1028		£10.97	28	15	m36 x 2	160	250	H0113-0221		£12.44
H0117-1029		£11.62	28	18	m36 x 2	160	250	H0113-0328		£13.93
H0117-1030		£12.17	28	22	m36 x 2	160	250	H0113-0387		£15.06
H0117-1953		£17.10	35	12	m45 x 2	160	250	H0113-0651		£0.00
H0117-1038		£20.21	35	15	m45 x 2	160	250	H0113-0426		£21.57
H0117-2299		£17.40	35	18	m45 x 2	160	250	H0113-0435		£19.85
H0117-1609		£16.14	35	22	m45 x 2	160	250	H0113-0439		£19.19
H0117-2107		£17.17	35	28	m45 x 2	160	250	H0113-0427		£20.67
H0117-1049		£31.27	42	18	m52 x 2	160	250	H0113-0232		£33.33
H0117-1050		£20.90	42	22	m52 x 2	160	250	H0113-0233		£23.68
H0117-2517		£21.32	42	28	m52 x 2	160	250	H0113-0234		£24.53
H0117-2451		£24.13	42	35	m52 x 2	160	250	H0113-0652		£30.07
<b>Light / Heavy Series</b>										
H0117-2351		£22.61	18	16	m26 x 1.5	315	400			
H0117-2350		£37.01	22	16	m30 x 2	160	250			
H0117-2348		£30.46	22	20	m30 x 2	160	250			
H0117-2786		£30.00	28	16	m36 x 2	160	250			
H0117-2788		£35.80	28	25	m36 x 2	160	250			
H0117-2898		£60.48	35	25	m45 x 2	160	250			
H0117-2896		£61.75	35	30	m45 x 2	160	250			
H0117-2742		£77.13	42	30	m52 x 2	160	250			
H0117-2894		£79.29	42	38	m52 x 2	160	250			
<b>Heavy Series</b>										
H0117-0975		£6.58	8	6	m16 x 1.5	630	900	H0117-1833		£7.28
H0117-0979		£4.38	10	6	m18 x 1.5	630	900	H0117-1835		£5.15
H0117-0977		£4.41	10	8	m18 x 1.5	630	900	H0113-0197		£5.26
H0117-0982		£3.81	12	6	m20 x 1.5	630	900	H0113-0199		£4.61
H0117-0984		£3.86	12	8	m20 x 1.5	630	900	H0113-0381		£4.73
H0117-0986		£4.02	12	10	m20 x 1.5	630	900	H0113-0335		£4.97
H0117-2914		£10.34	14	6	m22 x 1.5	630	700	H0113-0551		£10.86
H0117-2913		£10.12	14	8	m22 x 1.5	630	700	H0113-0552		£10.79
H0117-2912		£10.28	14	10	m22 x 1.5	630	700	H0113-0553		£11.05
H0117-2020		£10.40	14	12	m22 x 1.5	630	700	H0113-0554		£11.48
H0117-0991		£7.14	16	6	m24 x 1.5	400	630	H0113-0205		£7.83
H0117-0992		£5.16	16	8	m24 x 1.5	400	630	H0113-0206		£6.00
H0117-0993		£5.33	16	10	m24 x 1.5	400	630	H0113-0207		£6.25
H0117-0994		£5.44	16	12	m24 x 1.5	400	630	H0113-0208		£6.67
H0117-1002		£9.46	20	6	m30 x 2	400	630	H0113-0210		£10.08
H0117-1004		£8.90	20	8	m30 x 2	400	630	H0113-0374		£9.61



= Manufacturer's code **EXAMPLE** = Special Price

Technical Helpline  
0845 120 9891

**Tube End Reducers**

**RED Tube End Reducer**

EO Swivel / EO tube end.

EO Fittings							EO-2 Fittings			
Code		Price	Tube O.D. (mm) D1	Tube O.D.(mm) D2	Female Thread d1	PN (bar)	P max (bar)	Code		Price
H0117-1005	RED20/10SA3C	£7.80	20	10	m30 x 2	400	630	H0113-0211	RED20/10ZSA3C	£8.64
H0117-1006	RED20/12SA3C	£6.78	20	12	m30 x 2	400	630	H0113-0212	RED20/12ZSA3C	£7.97
H0117-1007	RED20/16SA3C	£7.67	20	16	m30 x 2	400	630	H0113-0213	RED20/16ZSA3C	£9.63
H0117-1014	RED25/06SA3C	£15.30	25	6	m36 x 2	400	630	H0113-0215	RED25/06ZSA3C	£16.19
H0117-1015	RED25/08SA3C	£15.03	25	8	m36 x 2	400	630	H0113-0216	RED25/08ZSA3C	£16.01
H0117-1017	RED25/10SA3C	£13.95	25	10	m36 x 2	400	630	H0113-0217	RED25/10ZSA3C	£15.03
H0117-1018	RED25/12SA3C	£11.27	25	12	m36 x 2	400	630	H0113-0218	RED25/12ZSA3C	£12.67
H0117-1913	RED25/14SA3C	£23.77	25	14	m36 x 2	400	630	H0113-0653	RED25/14ZSA3C	£26.24
H0117-1019	RED25/16SA3C	£11.50	25	16	m36 x 2	400	630	H0113-0219	RED25/16ZSA3C	£13.54
H0117-1021	RED25/20SA3C	£12.66	25	20	m36 x 2	400	630	H0113-0220	RED25/20ZSA3C	£15.39
H0117-1031	RED30/08SA3C	£18.31	30	8	m42 x 2	400	420	H0113-0354	RED30/08ZSA3C	£19.28
H0117-1032	RED30/10SA3C	£17.20	30	10	m42 x 2	400	420	H0113-0223	RED30/10ZSA3C	£18.27
H0117-1033	RED30/12SA3C	£14.73	30	12	m42 x 2	400	420	H0113-0224	RED30/12ZSA3C	£16.12
H0117-1034	RED30/16SA3C	£14.92	30	16	m42 x 2	400	420	H0113-0225	RED30/16ZSA3C	£17.11
H0117-1036	RED30/20SA3C	£15.34	30	20	m42 x 2	400	420	H0113-0226	RED30/20ZSA3C	£18.07
H0117-1037	RED30/25SA3C	£17.74	30	25	m42 x 2	400	420	H0113-0227	RED30/25ZSA3C	£21.72
H0117-1608	RED38/10SA3C	£0.00	38	10	m52 x 2	315	420	H0113-0520	RED38/10ZSA3C	£58.41
H0117-1042	RED38/12SA3C	£28.40	38	12	m52 x 2	315	420	H0113-0228	RED38/12ZSA3C	£29.45
H0117-1043	RED38/16SA3C	£24.50	38	16	m52 x 2	315	420	H0113-0229	RED38/16ZSA3C	£26.38
H0117-1044	RED38/20SA3C	£23.59	38	20	m52 x 2	315	420	H0113-0366	RED38/20ZSA3C	£26.01
H0117-1045	RED38/25SA3C	£25.32	38	25	m52 x 2	315	420	H0113-0230	RED38/25ZSA3C	£28.96
H0117-1047	RED38/30SA3C	£26.38	38	30	m52 x 2	315	420	H0113-0231	RED38/30ZSA3C	£31.64
<b>Heavy / Light Series</b>										
H0117-1832	RED16S/15LA3C	£11.44	16	15	m24 x 1.5	315	400			
H0117-2353	RED20S/15LA3C	£12.07	20	15	m30 x 2	315	400			
H0117-2919	RED20S/18LA3C	£15.19	20	18	m30 x 2	315	400			
H0117-2342	RED25S/18LA3C	£30.77	25	18	m36 x 2	315	400			
H0117-2343	RED25S/22LA3C	£30.93	25	22	m36 x 2	160	250			
H0117-1829	RED30S/22LA3C	£57.89	30	22	m42 x 2	160	250			
H0117-2035	RED30S/28LA3C	£59.46	30	28	m42 x 2	160	250			

Tube End Reducers & Distance Adaptors

**Distance Piece Adaptors**

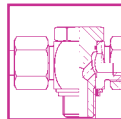
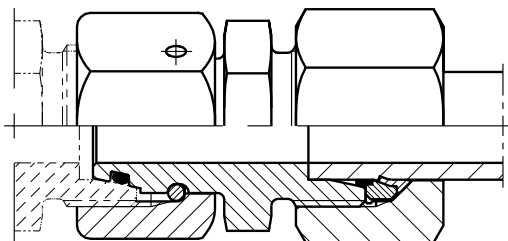

**DA Distance Piece Adaptor**

EO Swivel/EO tube end

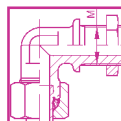

SECTION  
40



EO Fittings					EO-2 Fittings			
Code		Price	Tube O.D. (mm)	PN (bar)	P max (bar)	Code		Price
<b>Light Duty</b>								
H0113-0440	DA06ZLA3C	£10.61	6	315	500	H0113-0440	DA06ZLA3C	£10.61
H0113-0442	DA08ZLA3C	£11.18	8	315	500	H0113-0442	DA08ZLA3C	£11.18
H0113-0447	DA10ZLA3C	£11.95	10	315	500	H0113-0447	DA10ZLA3C	£11.95
H0113-0445	DA12ZLA3C	£12.60	12	315	400	H0113-0445	DA12ZLA3C	£12.60
H0113-0449	DA15ZLA3C	£13.90	15	315	400	H0113-0449	DA15ZLA3C	£13.90
H0113-0451	DA18ZLA3C	£15.88	18	315	400	H0113-0451	DA18ZLA3C	£15.88
H0113-0453	DA22ZLA3C	£19.09	22	160	250	H0113-0453	DA22ZLA3C	£19.09
H0113-0455	DA28ZLA3C	£28.77	28	160	250	H0113-0455	DA28ZLA3C	£28.77
H0113-0457	DA35ZLA3C	£37.72	35	160	250	H0113-0457	DA35ZLA3C	£37.72
H0113-0459	DA42ZLA3C	£48.17	42	160	250	H0113-0459	DA42ZLA3C	£48.17
<b>Heavy Duty</b>								
H0113-0441	DA06ZSA3C	£10.75	6	630	900	H0113-0441	DA06ZSA3C	£10.75
H0113-0443	DA08ZSA3C	£11.36	8	630	900	H0113-0443	DA08ZSA3C	£11.36
H0113-0444	DA10ZSA3C	£12.02	10	630	900	H0113-0444	DA10ZSA3C	£12.02
H0113-0446	DA12ZSA3C	£12.87	12	630	900	H0113-0446	DA12ZSA3C	£12.87
H0113-0448	DA14ZSA3C	£18.22	14	630	700	H0113-0448	DA14ZSA3C	£18.22
H0113-0450	DA16ZSA3C	£17.20	16	400	630	H0113-0450	DA16ZSA3C	£17.20
H0113-0452	DA20ZSA3C	£21.02	20	400	630	H0113-0452	DA20ZSA3C	£21.02
H0113-0454	DA25ZSA3C	£29.64	25	400	630	H0113-0454	DA25ZSA3C	£29.64
H0113-0456	DA30ZSA3C	£43.05	30	400	420	H0113-0456	DA30ZSA3C	£43.05
H0113-0458	DA38ZSA3C	£52.11	38	315	420	H0113-0458	DA38ZSA3C	£52.11

 = Manufacturer's code **EXAMPLE** = Special Price

Online Order  
www.lister.co.uk



## Tube to BSPP Straights



### GE-R-ED Male Stud Connector

EO tube end / Male BSPP thread.

• DIN 3852, Form E: Elastoc Seal ED.

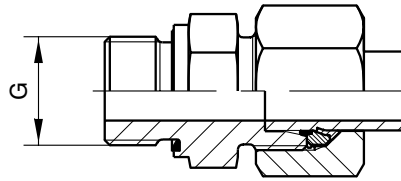

Straights

EO Fittings							EO-2 Fittings		
Code	Price	Tube O.D. (mm)	Male Thread BSPP G	PN (bar)	P max (bar)	Code	Price		
<b>Extra Light Duty</b>									
H0117-2907	£1.31	4	1/8	100	250	H0113-0657	£2.13		
H0117-2904	£1.32	6	1/8	100	250	H0113-0656	£2.24		
<b>Light Duty</b>									
H0117-0522	£1.34	6	1/8	315	500	H0113-0135	£2.14		
H0117-0520	£1.85	6	1/4	315	500	H0113-0134	£2.64		
H0117-0521	£2.41	6	3/8	315	500	H0113-0389	£3.18		
H0117-0519	£7.89	6	1/2	315	500	H0113-0375	£8.49		
H0117-0531	£2.40	8	1/8	315	500	H0113-0138	£3.24		
H0117-0749	£1.70	8	1/4	315	500	H0113-0140	£2.55		
H0117-0532	£2.24	8	3/8	315	500	H0113-0139	£3.08		
H0117-0530	£4.41	8	1/2	315	500	H0113-0323	£5.18		
H0117-2162	£3.50	10	1/8	315	500	H0113-0419	£4.54		
H0117-0552	£1.79	10	1/4	315	500	H0113-0147	£2.88		
H0117-0548	£2.20	10	3/8	315	500	H0113-0146	£3.28		
H0117-0545	£3.39	10	1/2	315	500	H0113-0145	£4.43		
H0117-0584	£2.37	12	1/4	315	400	H0113-0322	£3.53		
H0117-0590	£2.24	12	3/8	315	400	H0113-0153	£3.41		
H0117-0581	£3.20	12	1/2	315	400	H0113-0152	£4.34		
H0117-0587	£6.18	12	3/4	315	400	H0113-0347	£7.04		
H0117-0621	£3.52	15	3/8	315	400	H0113-0157	£5.03		
H0117-0625	£3.08	15	1/2	315	400	H0113-0158	£4.60		
H0117-0619	£9.89	15	3/4	315	400	H0113-0408	£8.22		
H0117-0651	£7.32	18	3/8	315	400	H0117-1614	£9.55		
H0117-0653	£3.80	18	1/2	315	400	H0113-0003	£6.19		
H0117-0649	£6.59	18	3/4	315	400	H0113-0163	£8.85		
H0117-2223	£34.11	18	1"	315	400	H0113-0654	£32.05		
H0115-0012	£13.85	22	3/4	160	250	H0113-0545	£17.02		
H0117-0673	£8.90	22	1/2	160	250	H0113-0168	£11.68		
H0117-0677	£5.41	22	3/4	160	250	H0113-0169	£8.30		
H0117-0674	£20.77	22	1"	160	250	H0113-0655	£23.56		
H0117-0694	£19.65	28	3/4	160	250	H0113-0546	£22.88		
H0117-0697	£9.62	28	1"	160	250	H0113-0173	£12.97		
H0117-2168	£0.00	28	1-1/4	160	250	H0113-0547	£15.87		
H0117-0496	£25.46	35	1"	160	250	H0113-0368	£31.39		
H0117-0708	£13.42	35	1-1/4	160	250	H0113-0176	£19.51		
H0117-2224	£39.76	35	1-1/2	160	250	H0113-0548	£41.19		
H0117-2166	£24.88	42	1-1/4	160	250	H0113-0430	£30.35		
H0117-0717	£16.31	42	1-1/2	160	250	H0113-0179	£24.47		
<b>Heavy Duty</b>									
H0117-0734	£1.76	6	1/4	630	900	H0113-0137	£2.62		
H0117-1855	£7.63	6	3/8	630	900		£		
H0117-0523	£9.43	6	1/2	630	900	H0113-0556	£10.04		
H0117-0757	£1.90	8	1/4	630	900	H0113-0143	£2.83		
H0117-0754	£4.11	8	3/8	630	900	H0113-0142	£4.97		
H0117-2105	£28.67	8	1/2	630	700	H0113-0658	£29.65		
H0117-0561	£3.24	10	1/4	630	900	H0113-0149	£4.22		
H0117-0564	£2.38	10	3/8	630	900	H0113-0150	£3.39		
H0117-0559	£3.56	10	1/2	630	900	H0113-0148	£4.53		
H0117-0602	£4.15	12	1/4	630	900	H0113-0155	£5.43		
H0117-0606	£2.56	12	3/8	630	900	H0113-0156	£3.89		
H0117-0598	£3.09	12	1/2	630	900	H0113-0154	£4.39		
H0117-0603	£11.43	12	3/4	630	900	H0113-0549	£13.29		
H0117-0609	£12.22	14	3/8	630	700	H0113-0659	£14.61		
H0117-0611	£4.28	14	1/2	630	700	H0113-0660	£6.94		
H0117-0636	£7.87	16	3/8	400	630	H0113-0161	£9.82		
H0117-0639	£4.18	16	1/2	400	630	H0113-0162	£6.25		
H0117-0633	£6.55	16	3/4	400	630	H0113-0160	£8.54		
H0117-2221	£13.83	16	1"	400	630	H0113-0557	£14.65		
H0117-0658	£10.01	20	1/2	400	630	H0113-0164	£12.43		
H0117-0663	£6.08	20	3/4	400	630	H0113-0166	£8.62		
H0117-0660	£29.63	20	1"	400	630	H0113-0165	£32.33		
H0117-0681	£25.08	25	1/2	400	630	H0113-0170	£28.73		
H0117-0684	£14.67	25	3/4	400	630	H0113-0171	£18.45		
H0117-0687	£10.31	25	1"	400	630	H0113-0172	£14.14		
H0117-1774	£42.09	25	1-1/4	400	630	H0117-2809	£46.55		
H0117-2222	£18.90	30	3/4	400	630	H0113-0561	£26.38		
H0117-0700	£18.60	30	1"	400	420	H0113-0174	£23.96		
H0117-0702	£15.59	30	1-1/4	400	420	H0113-0175	£20.97		
H0115-0001	£39.04	30	1-1/2	400	420	H0115-0003	£44.56		
H0117-0703	£21.82	38	1-1/4	315	420	H0113-0365	£28.62		
H0117-0712	£19.47	38	1-1/2	315	420	H0113-0177	£26.31		

☰ = Manufacturer's code **EXAMPLE** = Special Price

Technical Helpline  
0845 120 9891

**Tube to BSPP Straights**

**GAI-R Female Connector**

EO tube end / Female BSPP thread

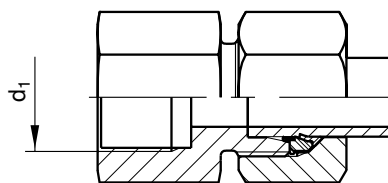

EO Fittings							EO-2 Fittings			
Code		Price	Tube O.D. (mm)	Female Thread BSPP (d1)	PN (bar)	P max (bar)	Code		Price	
<b>Light Duty</b>							<b>HO113-0118</b>		<b>£2.56</b>	
HO117-0507	GAI06LRA3C	£1.77	6	1/8	315	500	HO113-0360	GAI08ZLRA3C	£2.76	
HO117-0360	GAI08LRA3C	£1.90	8	1/4	315	500	HO113-0607	GAI08ZLR3/8A3C	£7.37	
HO117-1778	GAI08LR3/8A3C	£6.66	8	3/8	315	500	HO113-0661	GAI08ZLR1/2A3C	£11.00	
HO117-0474	GAI08LR1/2A3C	£10.42	8	1/2	315	500	HO113-0120	GAI10ZLRA3C	£3.14	
HO117-0476	GAI10LRA3C	£2.07	10	1/4	315	500	HO113-0121	GAI10ZLR3/8A3C	£11.38	
HO117-0478	GAI10LR3/8A3C	£10.57	10	3/8	315	500	HO113-0662	GAI10ZLR1/2A3C	£15.27	
HO117-0477	GAI10LR1/2A3C	£14.59	10	1/2	315	500	HO113-0123	GAI12ZLRA3C	£3.68	
HO117-0482	GAI12LRA3C	£2.53	12	3/8	315	400	HO113-0484	GAI12ZLR1/2A3C	£9.89	
HO117-0483	GAI12LR1/2A3C	£8.93	12	1/2	315	400	HO113-0123	GAI12ZLR3/8A3C	£3.68	
HO117-0482	GAI12LRA3C	£2.53	15	1/2	315	400	HO113-0123	GAI12ZLR1/2A3C	£3.68	
HO117-0493	GAI18LRA3C	£4.66	18	1/2	315	400	HO113-0575	GAI18ZLRA3C	£6.99	
HO117-0498	GAI22LRA3C	£6.92	22	3/4	160	250	HO113-0128	GAI22ZLRA3C	£9.77	
HO117-0500	GAI28LRA3C	£17.12	28	1"	160	250	HO113-0385	GAI28ZLRA3C	£20.62	
HO117-0503	GAI35LRA3C	£26.89	35	1-1/4	160	250	HO113-0130	GAI35ZLRA3C	£33.17	
HO117-0505	GAI42LRA3C	£29.53	42	1-1/2	160	250	HO113-0467	GAI42ZLRA3C	£37.53	
<b>Heavy Duty</b>							<b>HO113-0119</b>		<b>£4.28</b>	
HO117-0509	GAI06SRA3C	£3.48	6	1/4	400	630	HO113-0473	GAI08ZSRA3C	£4.44	
HO117-0513	GAI08SRA3C	£3.56	8	1/4	400	630	HO113-0349	GAI10ZSRA3C	£5.66	
HO117-0480	GAI10SRA3C	£4.66	10	3/8	400	630	HO113-0376	GAI12ZSRA3C	£6.00	
HO117-0485	GAI12SRA3C	£4.73	12	3/8	400	630	HO113-0663	GAI14ZSRA3C	£10.71	
HO117-0487	GAI14SRA3C	£8.18	14	1/2	400	630	HO113-0126	GAI16ZSRA3C	£8.43	
HO117-0491	GAI16SRA3C	£6.43	16	1/2	400	630	HO113-0127	GAI20ZSRA3C	£13.01	
HO117-0495	GAI20SRA3C	£10.61	20	3/4	315	400	HO113-0415	GAI25ZSRA3C	£23.98	
HO117-0499	GAI25SRA3C	£20.01	25	1"	315	400	HO113-0129	GAI30ZSRA3C	£32.91	
HO117-0501	GAI30SRA3C	£27.30	30	1-1/4	315	400	HO113-0132	GAI38ZSRA3C	£39.55	
HO117-0504	GAI38SRA3C	£32.43	38	1-1/2	250	315				

Straights

**Swivel to BSPP Straights**

**EGE-LR-ED Swivel Connector**

EO Swivel / Male BSPP thread

• With Eolastic Seal ED.

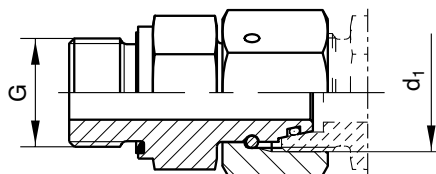

EO Fittings							EO-2 Fittings			
Code		Price	Tube O.D. D1 (mm)	Male Thread BSPP G	Female Thread d1	PN (bar)	P max (bar)	Code		Price
<b>Light Duty</b>							<b>HO117-0200</b>		<b>£3.15</b>	
HO117-0200	EGE06LREDA3C	£3.15	6	1/8	m12 x 1.5	315	500	HO117-0202	EGE08LREDA3C	£3.37
HO117-0202	EGE08LREDA3C	£3.37	8	1/4	m14 x 1.5	315	500	HO117-0204	EGE10LREDA3C	£3.49
HO117-0204	EGE10LREDA3C	£3.49	10	1/4	m16 x 1.5	315	500	HO117-2141	EGE10LR3/8EDA3C	£0.00
HO117-2141	EGE10LR3/8EDA3C	£0.00	10	3/8	m16 x 1.5	315	400	HO117-1792	EGE12LR1/4EDA3C	£4.31
HO117-1792	EGE12LR1/4EDA3C	£4.31	12	1/4	m18 x 1.5	315	400	HO117-0207	EGE12LREDA3C	£3.62
HO117-0207	EGE12LREDA3C	£3.62	12	3/8	m18 x 1.5	315	400	HO117-2044	EGE12LR1/2EDA3C	£3.94
HO117-2044	EGE12LR1/2EDA3C	£3.94	12	1/2	m18 x 1.5	315	400	HO117-0211	EGE15LREDA3C	£4.83
HO117-0211	EGE15LREDA3C	£4.83	15	1/2	m22 x 1.5	315	400	HO117-0213	EGE18LREDA3C	£5.45
HO117-0213	EGE18LREDA3C	£5.45	18	1/2	m26 x 1.5	315	400	HO117-2610	EGE18LR3/4EDA3C	£14.28
HO117-2610	EGE18LR3/4EDA3C	£14.28	18	3/4	m26 x 1.5	160	250	HO117-0215	EGE22LREDA3C	£8.13
HO117-0215	EGE22LREDA3C	£8.13	22	3/4	m30 x 2	160	250	HO117-0217	EGE28LREDA3C	£11.58
HO117-0217	EGE28LREDA3C	£11.58	28	1"	m36 x 2	160	250	HO117-0220	EGE35LREDA3C	£19.75
HO117-0220	EGE35LREDA3C	£19.75	35	1-1/4	m45 x 2	160	250	HO117-0222	EGE42LREDA3C	£22.23
HO117-0222	EGE42LREDA3C	£22.23	42	1-1/2	m52 x 2	160	250			
<b>Heavy Duty</b>							<b>HO117-0201</b>		<b>£3.61</b>	
HO117-0201	EGE06SREDA3C	£3.61	6	1/4	m14 x 1.5	630	900	HO117-0203	EGE08SREDA3C	£3.67
HO117-0203	EGE08SREDA3C	£3.67	8	1/4	m16 x 1.5	630	900	HO117-0205	EGE10SREDA3C	£3.73
HO117-0205	EGE10SREDA3C	£3.73	10	3/8	m18 x 1.5	630	900	HO117-0209	EGE12SR1/2EDA3C	£5.31
HO117-0209	EGE12SR1/2EDA3C	£5.31	12	3/8	m20 x 1.5	630	900	HO117-1789	EGE12SR1/2EDA3C	£5.31
HO117-1789	EGE12SR1/2EDA3C	£5.31	12	1/2	m20 x 1.5	630	700	HO117-2112	EGE14SREDA3C	£7.53
HO117-2112	EGE14SREDA3C	£7.53	14	1/2	m22 x 1.5	630	700	HO117-0212	EGE16SREDA3C	£6.00
HO117-0212	EGE16SREDA3C	£6.00	16	1/2	m24 x 1.5	400	630	HO117-0214	EGE20SREDA3C	£8.67
HO117-0214	EGE20SREDA3C	£8.67	20	3/4	m30 x 2	400	630	HO117-0216	EGE25SREDA3C	£12.15
HO117-0216	EGE25SREDA3C	£12.15	25	1"	m36 x 2	400	630	HO117-0219	EGE30SREDA3C	£18.47
HO117-0219	EGE30SREDA3C	£18.47	30	1-1/4	m42 x 2	400	420	HO117-0221	EGE38SREDA3C	£29.19
HO117-0221	EGE38SREDA3C	£29.19	38	1-1/2	m52 x 2	315	420			

= Manufacturer's code **EXAMPLE** = Special Price

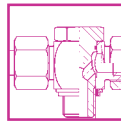

SECTION  
**40**

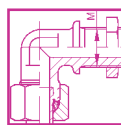

**Online Order**  
[www.lister.co.uk](http://www.lister.co.uk)

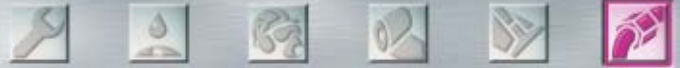

## Tube to BSP Locknut Adjustables



### WEE-R Male Stud 90° Elbow, Adjustable Locknut

EO tube end / Male BSPP thread with O - ring seal

- For ports with small or wide spot face

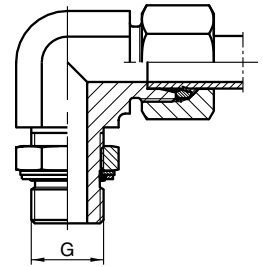

Locknut Adjustables

EO Fittings							EO-2 Fittings		
Code	Image	Price	Tube O.D. (mm)	Male Thread BSPP G	PN (bar)	P max (bar)	Code	Image	Price
<b>Extra Light Series</b>									
HD117-2939	WEE04LRA3C	£9.91	4	1/8	250	315			
HD117-2940	WEE06LRA3C	£10.03	6	1/8	250	315			
<b>Light Series</b>									
HD117-1645	WEE06LRA3C	£6.81	6	1/8	315	420	HD113-0472	WEE06ZLRA3C	£7.46
HD117-1644	WEE08LRA3C	£7.08	8	1/4	315	420	HD117-2437	WEE08ZLRA3C	£7.77
HD117-1637	WEE10LRA3C	£7.67	10	1/4	315	420	HD113-0541	WEE10ZLRA3C	£8.57
HD117-1604	WEE12LRA3C	£8.55	12	3/8	250	400	HD113-0474	WEE12ZLRA3C	£9.83
HD117-1646	WEE15LRA3C	£10.19	15	1/2	250	400	HD113-0542	WEE15ZLRA3C	£11.49
HD117-1647	WEE18LRA3C	£11.81	18	1/2	250	400	HD113-0544	WEE18ZLRA3C	£13.92
HD117-1648	WEE22LRA3C	£14.27	22	3/4	160	250	HD113-0543	WEE22ZLRA3C	£16.89
HD117-1649	WEE28LRA3C	£25.35	28	1"	160	250	HD113-0540	WEE28ZLRA3C	£28.05
HD117-1650	WEE35LRA3C	£40.34	35	1-1/4	160	250	HD113-0538	WEE35ZLRA3C	£28.05
HD117-1651	WEE42LRA3C	£51.28	42	1-1/2	160	250	HD113-0537	WEE42ZLRA3C	£59.01
<b>Heavy Series</b>									
HD117-1652	WEE06SRA3C	£7.07	6	1/4	315	500	HD113-0539	WEE06ZSRA3C	£7.77
HD117-1653	WEE08SRA3C	£7.64	8	1/4	315	500	HD117-2886	WEE08ZSRA3C	£8.39
HD117-1654	WEE10SRA3C	£8.55	10	3/8	250	400	HD117-2890	WEE10ZSRA3C	£9.37
HD117-1655	WEE12SRA3C	£9.11	12	3/8	250	400	HD117-2885	WEE12ZSRA3C	£10.23
HD117-1656	WEE16SRA3C	£11.90	16	1/2	250	400	HD117-2884	WEE16ZSRA3C	£13.72
HD117-1657	WEE20SRA3C	£14.52	20	3/4	250	400	HD117-2883	WEE20ZSRA3C	£16.81
HD117-1658	WEE25SRA3C	£25.82	25	1"	250	400	HD117-2882	WEE25ZSRA3C	£16.63
HD117-1659	WEE30SRA3C	£40.71	30	1-1/4	160	250	HD117-2887	WEE30ZSRA3C	£45.79
HD117-1660	WEE38SRA3C	£53.03	38	1-1/2	160	250	HD117-2888	WEE38ZSRA3C	£59.47

### VEE-R Male Stud 45° Elbow, Adjustable Locknut

EO tube end / Male BSPP thread with O - ring seal

- For ports with small or wide spot face

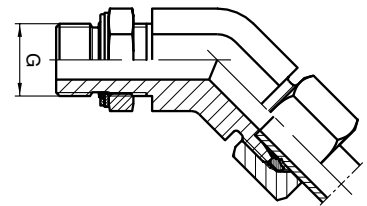

EO Fittings							EO-2 Fittings		
Code	Image	Price	Tube O.D. (mm)	Male Thread BSPP	PN (bar)	P max (bar)	Code	Image	Price
<b>Light Series</b>									
HD117-2546	VEE06LRA3C	£14.65	6	1/8	315	420	HD113-0666	VEE06ZLRA3C	£15.03
HD117-2545	VEE08LRA3C	£16.66	8	1/4	315	420	HD113-0665	VEE08ZLRA3C	£17.05
HD117-2544	VEE10LRA3C	£17.43	10	1/4	315	420	HD113-0664	VEE10ZLRA3C	£18.02
HD117-2340	VEE12LRA3C	£16.96	12	3/8	250	400	HD117-2364	VEE12ZLRA3C	£17.65
HD117-2547	VEE15LRA3C	£17.06	15	1/2	250	400	HD113-0667	VEE15ZLRA3C	£18.13
HD117-2548	VEE18LRA3C	£22.53	18	1/2	250	400	HD113-0668	VEE18ZLRA3C	£24.29
HD117-2549	VEE22LRA3C	£31.32	22	3/4	160	250	HD113-0669	VEE22ZLRA3C	£33.40
HD117-2933	VEE28LRA3C	£46.05	28	1"	160	250	HD113-0670	VEE28ZLRA3C	£48.96
HD117-2934	VEE35LRA3C	£76.57	35	1-1/4	160	250	HD113-0671	VEE35ZLRA3C	£81.88
HD117-2935	VEE42LRA3C	£82.72	42	1-1/2	160	250	HD113-0672	VEE42ZLRA3C	£90.07
<b>Standard Series</b>									
HD117-2555	VEE06SRA3C	£16.66	6	1/4	315	500	HD113-0681	VEE06ZSRA3C	£17.04
HD117-2554	VEE08SRA3C	£17.39	8	1/4	315	500	HD113-0680	VEE08ZSRA3C	£17.84
HD117-2553	VEE10SRA3C	£16.96	10	3/8	250	400	HD113-0679	VEE10ZSRA3C	£17.51
HD117-2552	VEE12SRA3C	£17.72	12	3/8	250	400	HD113-0678	VEE12ZSRA3C	£18.56
HD117-2551	VEE16SRA3C	£22.61	16	1/2	250	400	HD113-0677	VEE16ZSRA3C	£24.10
HD117-2550	VEE20SRA3C	£31.59	20	3/4	250	400	HD113-0676	VEE20ZSRA3C	£33.33
HD117-2936	VEE25SRA3C	£46.52	25	1"	250	400	HD113-0675	VEE25ZSRA3C	£49.92
HD117-2937	VEE30SRA3C	£76.93	30	1-1/4	160	250	HD113-0674	VEE30ZSRA3C	£81.58
HD117-2938	VEE38SRA3C	£84.47	38	1-1/2	160	250	HD113-0673	VEE38ZSRA3C	£90.52

Image icon = Manufacturer's code **EXAMPLE** = Special Price

Technical Helpline  
0845 120 9891



**Tube to BSP Locknut Adjustables**

**TEE-R Male Branch Tee, Adjustable Locknut**

EO tube end / Male BSPP thread with O - ring seal

• For ports with small or wide spot face

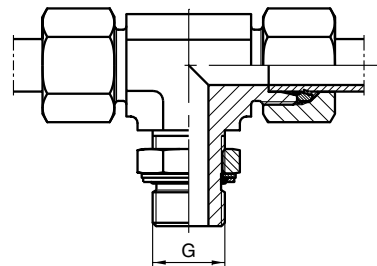

EO Fittings						
Code		Price	Tube O.D. (mm)	Male Thread BSPP G	PN (bar)	P max (bar)
<b>Light Series</b>						
H0117-2811	TEE06LRA3C	£8.97	6	1/8	315	420
H0117-2810	TEE08LRA3C	£9.33	8	1/4	315	420
H0117-1671	TEE10LRA3C	£10.81	10	1/4	315	420
H0117-2813	TEE12LRA3C	£11.99	12	3/8	250	400
H0117-2814	TEE15LRA3C	£13.93	15	1/2	250	400
H0117-2815	TEE18LRA3C	£17.03	18	1/2	250	400
H0117-2816	TEE22LRA3C	£22.90	22	3/4	160	250
H0117-2817	TEE28LRA3C	£42.75	28	1"	160	250
H0117-2818	TEE35LRA3C	£53.33	35	1-1/4	160	250
H0117-2820	TEE42LRA3C	£66.51	42	1-1/2	160	250
<b>Standard Series</b>						
H0117-2924	TEE06SRA3C	£9.32	6	1/4	315	500
H0117-2925	TEE08SRA3C	£10.73	8	1/4	315	500
H0117-2926	TEE10SRA3C	£11.99	10	3/8	250	400
H0117-2927	TEE12SRA3C	£13.65	12	3/8	250	400
H0117-2928	TEE16SRA3C	£17.21	16	1/2	250	400
H0117-2929	TEE20SRA3C	£23.42	20	3/4	250	400
H0117-2930	TEE25SRA3C	£43.71	25	1"	250	400
H0117-2931	TEE30SRA3C	£54.06	30	1-1/4	160	250
H0117-2932	TEE38SRA3C	£70.01	38	1-1/2	160	250

EO-2 Fittings						
Code		Price				
H0113-0497	TEE06ZLRA3C	£10.38				
H0117-2436	TEE08ZLRA3C	£10.87				
H0113-0489	TEE10ZLRA3C	£12.75				
H0113-0490	TEE12ZLRA3C	£14.08				
H0113-0491	TEE15ZLRA3C	£16.72				
H0113-0492	TEE18ZLRA3C	£21.45				
H0113-0493	TEE22ZLRA3C	£28.31				
H0113-0494	TEE28ZLRA3C	£48.72				
H0113-0495	TEE35ZLRA3C	£65.17				
H0113-0496	TEE42ZLRA3C	£82.40				
H0113-0696	TEE06ZSRA3C	£10.86				
H0113-0697	TEE08ZSRA3C	£12.38				
H0113-0698	TEE10ZSRA3C	£13.79				
H0113-0699	TEE12ZSRA3C	£16.04				
H0113-0700	TEE16ZSRA3C	£21.06				
H0113-0701	TEE20ZSRA3C	£28.17				
H0113-0702	TEE25ZSRA3C	£50.62				
H0113-0703	TEE30ZSRA3C	£64.56				
H0113-0704	TEE38ZSRA3C	£83.31				

**LEE-R Adjustable Locknut Run Tee**

EO tube end / Male BSPP thread with O - ring seal

• For ports with small or wide spot face

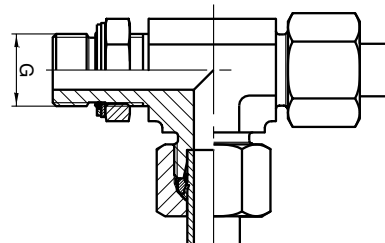

EO Fittings						
Code		Price	Tube O.D. (mm)	Male Thread BSPP G	PN (bar)	P max (bar)
<b>Light Duty</b>						
H0117-2755	LEE06LRA3C	£8.97	6	1/8	315	420
H0117-2754	LEE08LRA3C	£9.33	8	1/4	315	420
H0117-2753	LEE10LRA3C	£10.81	10	1/4	315	420
H0117-2752	LEE12LRA3C	£11.99	12	3/8	250	400
H0117-2750	LEE15LRA3C	£13.93	15	1/2	250	400
H0117-2751	LEE18LRA3C	£17.03	18	1/2	250	400
H0117-2749	LEE22LRA3C	£22.90	22	3/4	160	250
H0117-2746	LEE28LRA3C	£42.28	28	1"	160	250
H0117-2747	LEE35LRA3C	£53.33	35	1-1/4	160	250
H0117-2748	LEE42LRA3C	£66.51	42	1-1/2	160	250
<b>Heavy Duty</b>						
H0117-2756	LEE06SRA3C	£9.32	6	1/4	315	500
H0117-2757	LEE08SRA3C	£10.73	8	1/4	315	500
H0117-2758	LEE10SRA3C	£11.99	10	3/8	250	400
H0117-2759	LEE12SRA3C	£13.65	12	3/8	250	400
H0117-2760	LEE16SRA3C	£17.21	16	1/2	250	400
H0117-2761	LEE20SRA3C	£23.42	20	3/4	250	400
H0117-2762	LEE25SRA3C	£43.24	25	1"	250	400
H0117-2763	LEE30SRA3C	£54.06	30	1-1/4	160	250
H0117-2764	LEE38SRA3C	£70.01	38	1-1/2	160	250

EO-2 Fittings						
Code		Price				
H0117-2765	LEE06ZLRA3C	£10.38				
H0117-2766	LEE08ZLRA3C	£10.87				
H0117-2767	LEE10ZLRA3C	£12.75				
H0117-2768	LEE12ZLRA3C	£14.08				
H0117-2769	LEE15ZLRA3C	£16.72				
H0117-2770	LEE18ZLRA3C	£21.45				
H0117-2771	LEE22ZLRA3C	£28.31				
H0117-2772	LEE28ZLRA3C	£48.72				
H0117-2773	LEE35ZLRA3C	£65.17				
H0117-2774	LEE42ZLRA3C	£82.40				
H0117-2783	LEE06ZSRA3C	£10.86				
H0117-2782	LEE08ZSRA3C	£12.38				
H0117-2781	LEE10ZSRA3C	£13.79				
H0117-2780	LEE12ZSRA3C	£16.04				
H0117-2779	LEE16ZSRA3C	£21.06				
H0117-2778	LEE20ZSRA3C	£28.17				
H0117-2777	LEE25ZSRA3C	£50.62				
H0117-2776	LEE30ZSRA3C	£64.56				
H0117-2775	LEE38ZSRA3C	£83.31				

= Manufacturer's code **EXAMPLE** = Special Price

Locknut Adjustables

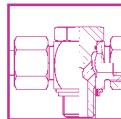

SECTION  
**40**

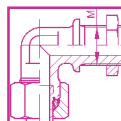

Online Order  
[www.lister.co.uk](http://www.lister.co.uk)



## Tube to BSP Banjos



### Banjo Fittings

This high pressure series supplements the medium pressure SWVE series.

Assembly: To achieve optimum sealing, we recommend tightening the hollow bolts with the torques listed. O-rings to be oiled before assembly.

#### Advantages:

- Compact design of elbow and Tee versions
- Extended range of applications due to high working pressures and availability in special materials such as stainless steel 1.4571 and brass (CuZn35Ni2) as well as the standard steel version

#### Advantages (continued):

- Simplified assembly and improved sealing and also a choice of seals
- The sealing of male studs is either by sealing rings KDS with vulcanized soft sealing (NBR) or by hardened metal rings (DKA)
- Sealing between hollow bolt and body is achieved by an internal O-ring made of NBR (eg. Buna N) or, on request, of FPM (eg. Viton). An additional metallic seal is achieved by the cutting face of the hollow bolt
- By optimising the internal features and using hollow bolts with cross-drilled holes, minimum flow disruption is achieved. Measured values available on request

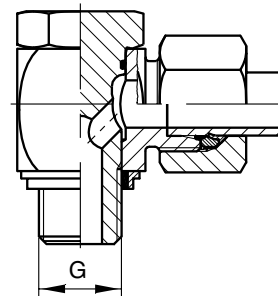

### WH-R-KDS Banjo Elbow High Pressure

EO tube end / Male BSPP thread with soft seal ring

EO Fittings							EO-2 Fittings		
Code	Image	Price	Tube O.D. (mm)	Male Thread BSPP G	DN (bar)	P max (bar)	Code	Image	Price
<b>Light Duty</b>									
HO117-1466		£8.71	6	1/8	315	400	HO113-0294		£9.29
HO117-1472		£9.41	8	1/4	315	400	HO113-0296		£10.03
HO117-1434		£9.60	10	1/4	315	400	HO113-0299		£10.44
HO117-1439		£12.20	12	3/8	315	400	HO113-0301		£13.04
HO117-1445		£14.71	15	1/2	315	400	HO113-0303		£15.86
HO117-1451		£19.31	18	1/2	315	400	HO113-0305		£21.17
HO117-1455		£33.00	22	3/4	160	250	HO113-0431		£31.95
HO117-1459		£45.91	28	1"	160	250	HO113-0308		£48.83
HO117-1630		£69.49	35	1-1/4	160	250	HO113-0434		£74.90
HO117-1464		£91.21	42	1-1/2	160	250	HO113-0558		£98.47
<b>Heavy Duty</b>									
HO117-1468		£9.41	6	1/4	400	500	HO113-0295		£10.03
HO117-1431		£9.75	8	1/4	400	500	HO113-0297		£10.44
HO117-1436		£12.46	10	3/8	400	500	HO113-0300		£13.16
HO117-1441		£12.60	12	3/8	400	500	HO113-0302		£13.61
HO117-1447		£19.35	16	1/2	315	400	HO113-0418		£20.95
HO117-1453		£30.96	20	3/4	315	400	HO113-0306		£32.72
HO117-1457		£46.74	25	1"	250	315	HO113-0391		£50.13
HO117-1460		£71.89	30	1-1/4	160	250	HO113-0309		£76.60
HO117-1463		£96.29	38	1-1/2	160	250	HO113-0464		£102.20

### TH-R-KDS Banjo Tee

EO tube end / Male BSPP thread with soft seal ring

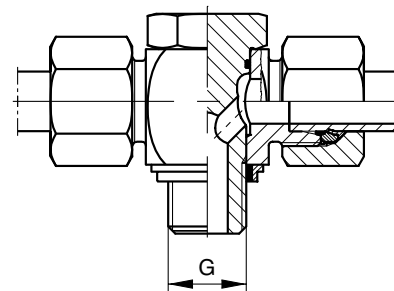

EO Fittings						EO-2 Fittings			
Code	Image	Price	Tube O.D. (mm)	Male Thread BSPP G	PN (bar)	P max (bar)	Code	Image	Price
<b>Light Duty</b>									
HO117-1217		£14.95	6	1/8	315	400	HO117-2090		£15.81
HO117-1219		£16.30	8	1/4	315	400	HO113-0509		£17.61
HO117-1615		£18.56	10	1/4	315	400	HO113-0510		£20.27
HO117-1222		£20.29	12	3/8	315	400	HO113-0505		£22.11
HO117-2839		£28.99	15	1/2	315	400	HO113-0506		£31.30
HO117-1226		£35.00	18	1/2	315	400	HO113-0507		£38.84
HO117-2840		£54.28	22	3/4	160	250	HO113-0508		£58.68
HO117-2841		£79.29	28	1"	160	250	HO113-0517		£85.28
HO117-2842		£108.62	35	1-1/4	160	250	HO113-0518		£119.79
HO117-2843		£134.02	42	1-1/2	160	250	HO113-0519		£149.10
<b>Heavy Duty</b>									
HO117-1218		£17.09	6	1/4	400	500	HO113-0511		£18.36
HO117-1220		£19.34	8	1/4	400	500	HO113-0275		£20.71
HO117-1221		£21.54	10	3/8	400	500	HO113-0512		£23.04
HO117-1223		£27.46	12	3/8	400	500	HO113-0276		£29.41
HO117-1224		£37.47	16	1/2	315	400	HO113-0513		£41.31
HO117-1227		£56.32	20	3/4	315	400	HO113-0514		£60.00
HO117-2846		£83.32	25	1"	250	315	HO113-0515		£90.22
HO117-2845		£109.79	30	1-1/4	160	250	HO113-0277		£119.61
HO117-2844		£142.99	38	1-1/2	160	250	HO113-0516		£155.41

= Manufacturer's code **EXAMPLE** = Special Price

Banjos

SECTION  
40

Technical Helpline  
0845 120 9891

**Pressure Gauge Adaptors**

**MAV Pressure Gauge Connector**

EO tube end / Female BSPP Gauge Connection

- With metal sealing ring DK1

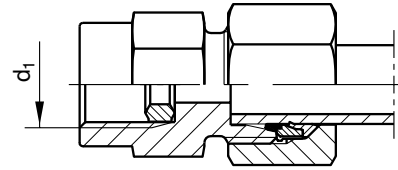

EO Fittings						EO-2 Fittings			
Code		Price	Tube O.D. (mm)	Female Thread BSPP d1	PN (bar)	P max (bar)	Code		Price
<b>Extra Light Duty</b>									
H0117-0948	MAV04LLRA3C	£6.12	4	1/4	100	250			£
<b>Light Duty</b>									
H0117-0949	MAV06LRA3C	£2.49	6	1/4	315	500	H0113-0192	MAV06ZLRA3C	£3.26
H0117-0952	MAV08LRA3C	£2.52	8	1/4	315	500	H0113-0193	MAV08ZLRA3C	£3.36
H0117-0939	MAV10LRA3C	£2.80	10	1/4	315	500	H0113-0423	MAV10ZLRA3C	£3.86
H0117-0944	MAV12LRA3C	£3.07	12	1/4	315	500	H0113-0705	MAV12ZLRA3C	£4.20
<b>Heavy Duty</b>									
H0117-0950	MAV06SRA3C	£4.41	6	1/2	630	900	H0113-0603	MAV06ZSRA3C	£5.07
H0117-0953	MAV08SRA3C	£4.49	8	1/2	630	900	H0113-0706	MAV08ZSRA3C	£5.34
H0117-0940	MAV10SRA3C	£4.69	10	1/2	630	900	H0113-0707	MAV10ZSRA3C	£5.62
H0117-0945	MAV12SRA3C	£4.81	12	1/2	630	900	H0113-0708	MAV12ZSRA3C	£6.07

**MAVE Pressure Gauge Swivel Connector**

EO Swivel / Female BSPP Gauge Connection

- With metal sealing ring DK1

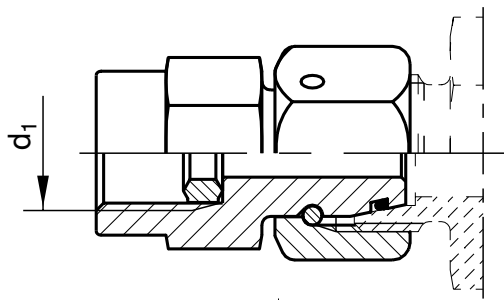

Code		Tube O.D. (mm)	Female Thread BSPP d1	PN (bar)	P max (bar)	Price
<b>Light Duty</b>						
H0117-0961	MAVE06LRA3C	6	1/4	315	500	£4.03
H0117-0964	MAVE08LRA3C	8	1/4	315	500	£4.07
H0117-0955	MAVE10LRA3C	10	1/4	315	500	£4.16
H0117-0958	MAVE12LRA3C	12	1/4	315	500	£4.18
<b>Heavy Duty</b>						
H0117-2806	MAVE06SR1/4A3C	6	1/4	630	900	£18.31
H0117-0962	MAVE06SRA3C	6	1/2	630	900	£7.60
H0117-2061	MAVE08SR1/4A3C	8	1/4	630	900	£19.80
H0117-0966	MAVE08SRA3C	8	1/2	630	900	£7.19
H0117-2807	MAVE10SR1/4A3C	10	1/4	630	900	£21.29
H0117-0957	MAVE10SRA3C	10	1/2	630	900	£7.36
H0117-2808	MAVE12SR1/4A3C	12	1/4	630	900	£22.83
H0117-0959	MAVE12SRA3C	12	1/2	630	900	£7.17

= Manufacturer's code **EXAMPLE** = Special Price

Pressure Gauge Adaptors

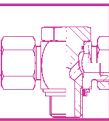

SECTION  
**40**

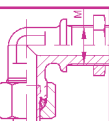

Online Order  
[www.lister.co.uk](http://www.lister.co.uk)

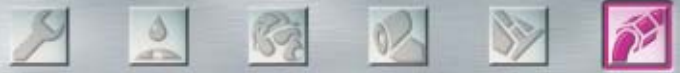

## Tube to Metric Parallel Straights



### GE-M-ED Male Stud Connector

EO tube end / Male metric parallel thread

• With Eolastic seal ED

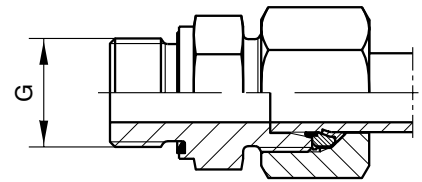

EO Fittings							EO-2 Fittings			
Code		Price	Tube O.D. (mm)	Male Thread Metric G	PN (bar)	P max (bar)	Code		Price	
<b>Light Duty</b>										
H0117-0518	GE08LMEDA3C	£1.35	6	m10 x 1	315	500	H0113-0133	GE08ZLMEDA3C	£2.15	
H0117-0741	GE08LMEDA3C	£1.60	8	m12 x 1.5	315	500	H0113-0386	GE08ZLMEDA3C	£2.47	
H0117-0543	GE10LMEDA3C	£1.79	10	m14 x 1.5	315	500	H0113-0144	GE10ZLMEDA3C	£2.88	
H0117-2540	GE10LM16X1.5EDA3C	£3.10	10	m16 x 1.5	315	500	H0113-0356	GE10ZLM16X1.5EDA3C	£4.15	
H0117-2539	GE10LM18X1.5EDA3C	£4.08	10	m18 x 1.5	315	500	H0113-0606	GE10ZLM18X1.5EDA3C	£5.10	
H0117-2627	GE10LM22X1.5EDA3C	£7.53	10	m22 x 1.5	315	500	H0113-0709	GE10ZLM22X1.5EDA3C	£8.44	
H0117-2649	GE12LM14X1.5EDA3C	£5.56	12	m14 x 1.5	315	400	H0113-0711	GE12ZLM14X1.5EDA3C	£6.63	
H0117-0579	GE12LMEDA3C	£2.24	12	m16 x 1.5	315	400	H0113-0151	GE12ZLMEDA3C	£3.41	
H0117-1748	GE12LM18X1.5EDA3C	£3.76	12	m18 x 1.5	315	400	H0113-0710	GE12ZLM18X1.5EDA3C	£4.87	
H0117-1749	GE12LM22X1.5EDA3C	£4.25	12	m22 x 1.5	315	400	H0113-0712	GE12ZLM22X1.5EDA3C	£5.35	
H0117-2297	GE15LM16X1.5EDA3C	£5.99	15	m16 x 1.5	315	400	H0113-0714	GE15ZLM16X1.5EDA3C	£7.42	
H0117-0616	GE15LMEDA3C	£2.67	15	m18 x 1.5	315	400	H0113-0521	GE15ZLMEDA3C	£4.21	
H0117-1756	GE15LM22X1.5EDA3C	£4.41	15	m22 x 1.5	315	400	H0113-0713	GE15ZLM22X1.5EDA3C	£6.02	
H0117-2652	GE18LM18X1.5EDA3C	£4.08	18	m18 x 1.5	315	400	H0113-0715	GE18ZLM18X1.5EDA3C	£6.48	
H0117-0646	GE18LMEDA3C	£3.82	18	m22 x 1.5	315	250	H0113-0716	GE18ZLMEDA3C	£6.17	
H0117-2654	GE22LM22X1.5EDA3C	£16.09	22	m22 x 1.5	160	250	H0113-0717	GE22ZLM22X1.5EDA3C	£18.65	
H0117-0670	GE22LMEDA3C	£5.47	22	m26 x 1.5	160	250	H0113-0167	GE22ZLMEDA3C	£8.37	
H0117-0692	GE28LMEDA3C	£9.30	28	m33 x 2	160	250	H0113-0392	GE28ZLMEDA3C	£12.66	
H0117-0705	GE35LMEDA3C	£13.32	35	m42 x 2	160	250	H0113-0718	GE35ZLMEDA3C	£19.41	
H0117-0715	GE42LMEDA3C	£16.65	42	m48 x 2	160	250	H0113-0719	GE42ZLMEDA3C	£24.80	
<b>Heavy Duty</b>										
H0117-0730	GE06SMEDA3C	£1.74	6	m12 x 1.5	630	900	H0113-0136	GE06ZSMEDA3C	£2.60	
H0117-0534	GE08SMEDA3C	£1.92	8	m14 x 1.5	630	900	H0113-0141	GE08ZSMEDA3C	£2.85	
H0117-0557	GE10SMEDA3C	£2.37	10	m16 x 1.5	630	900	H0113-0388	GE10ZSMEDA3C	£3.39	
H0117-0596	GE12SMEDA3C	£2.61	12	m18 x 1.5	630	900	H0113-0720	GE12ZSMEDA3C	£3.93	
H0117-2650	GE12SM22X1.5EDA3C	£14.29	12	m22 x 1.5	630	900	H0113-0721	GE12ZSM22X1.5EDA3C	£15.24	
H0117-0608	GE14SMEDA3C	£4.42	14	m20 x 1.5	630	700	H0113-0722	GE14ZSMEDA3C	£7.06	
H0117-1901	GE16SM18X1.5EDA3C	£7.57	16	m18 x 1.5	400	630	H0113-0723	GE16ZSM18X1.5EDA3C	£9.54	
H0117-0630	GE16SMEDA3C	£4.18	16	m22 x 1.5	400	630	H0113-0159	GE16ZSMEDA3C	£6.25	
H0117-0656	GE20SMEDA3C	£6.12	20	m27 x 2	400	630	H0113-0724	GE20ZSMEDA3C	£8.66	
H0117-0680	GE25SMEDA3C	£10.24	25	m33 x 2	400	630	H0113-0725	GE25ZSMEDA3C	£14.06	
H0117-0699	GE30SMEDA3C	£15.41	30	m42 x 2	400	420	H0113-0726	GE30ZSMEDA3C	£20.81	
H0117-0710	GE38SMEDA3C	£19.47	38	m48 x 2	315	420	H0113-0727	GE38ZSMEDA3C	£26.31	

Straights

## Swivel to Metric Parallel Straights

### EGE-M-ED Swivel Connector

EO Swivel / Male metric parallel thread

• With Eolastic seal ED

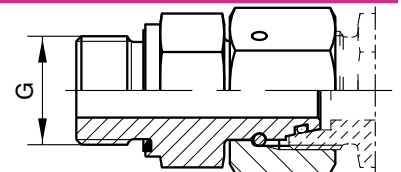

EO Fittings							EO-2 Fittings			
Code		Price	Tube O.D. D1 (mm)	Male Thread Metric	Female Thread d1	PN (bar)	P max (bar)	Code		Price
<b>Light Duty</b>										
H0117-0199	EGE08LMEDA3C	£3.59	6	m10 x 1	m12 x 1.5	315	500	H0117-0199	EGE08LMEDA3C	£3.59
H0117-1638	EGE08LMEDA3C	£3.70	8	m12 x 1.5	m14 x 1.5	315	500	H0117-1638	EGE08LMEDA3C	£3.70
H0117-1639	EGE10LMEDA3C	£3.82	10	m14 x 1.5	m16 x 1.5	315	500	H0117-1639	EGE10LMEDA3C	£3.82
H0117-1618	EGE12LMEDA3C	£4.21	12	m16 x 1.5	m18 x 1.5	315	400	H0117-1618	EGE12LMEDA3C	£4.21
H0117-0210	EGE15LMEDA3C	£4.99	15	m18 x 1.5	m22 x 1.5	315	400	H0117-0210	EGE15LMEDA3C	£4.99
H0117-2069	EGE18LMEDA3C	£5.65	18	m22 x 1.5	m26 x 1.5	315	400	H0117-2069	EGE18LMEDA3C	£5.65
H0117-2725	EGE22LMEDA3C	£8.52	22	m26 x 1.5	m30 x 2	160	250	H0117-2725	EGE22LMEDA3C	£8.52
H0117-2726	EGE28LMEDA3C	£13.53	28	m38 x 2	m36 x 2	160	250	H0117-2726	EGE28LMEDA3C	£13.53
H0117-2727	EGE35LMEDA3C	£20.59	35	m42 x 2	m45 x 2	160	250	H0117-2727	EGE35LMEDA3C	£20.59
H0117-2728	EGE42LMEDA3C	£23.50	42	m48 x 2	m52 x 2	160	250	H0117-2728	EGE42LMEDA3C	£23.50
<b>Heavy Duty</b>										
H0117-2729	EGE06SMEDA3C	£4.22	6	m12 x 1.5	m14 x 1.5	630	900	H0117-2729	EGE06SMEDA3C	£4.22
H0117-2730	EGE08SMEDA3C	£4.36	8	m14 x 1.5	m16 x 1.5	630	900	H0117-2730	EGE08SMEDA3C	£4.36
H0117-2731	EGE10SMEDA3C	£4.46	10	m16 x 1.5	m18 x 1.5	630	900	H0117-2731	EGE10SMEDA3C	£4.46
H0117-2732	EGE12SMEDA3C	£4.67	12	m18 x 1.5	m20 x 1.5	630	900	H0117-2732	EGE12SMEDA3C	£4.67
H0117-2921	EGE14SMEDA3C	£7.88	14	m20 x 1.5	m22 x 1.5	630	700	H0117-2921	EGE14SMEDA3C	£7.88
H0117-2733	EGE16SMEDA3C	£6.31	16	m22 x 1.5	m24 x 1.5	400	630	H0117-2733	EGE16SMEDA3C	£6.31
H0117-2734	EGE20SMEDA3C	£9.57	20	m27 x 2	m30 x 2	400	630	H0117-2734	EGE20SMEDA3C	£9.57
H0117-2735	EGE25SMEDA3C	£14.31	25	m38 x 2	m36 x 2	400	630	H0117-2735	EGE25SMEDA3C	£14.31
H0117-0218	EGE30SMEDA3C	£21.43	30	m42 x 2	m42 x 2	400	420	H0117-0218	EGE30SMEDA3C	£21.43
H0117-2736	EGE38SMEDA3C	£31.80	38	m48 x 2	m52 x 2	315	420	H0117-2736	EGE38SMEDA3C	£31.80

= Manufacturer's code **EXAMPLE** = Special Price

SECTION  
40

Technical Helpline  
0845 120 9891

**Tube to Metric Locknut Adjustables**

**WEE-OR Male Stud 90° Elbow, Adjustable Locknut**

EO tube end / Male parallel thread

- With O - ring seal for ports with small or wide spot face

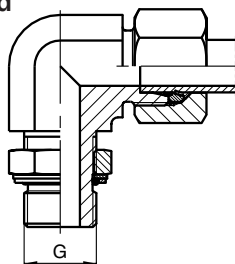

Code	Tube O.D. (mm)	Male Thread G	PN (bar)	P max (bar)	Price	
<b>Light Duty</b>						
H0117-2992	WEE06LMA3C	6	M10 x 1	315	420	£0.00
H0117-2993	WEE08LMA3C	8	M12 x 1.5	315	420	£0.00
H0117-2994	WEE10LMA3C	10	M14 x 1.5	315	420	£0.00
H0117-2995	WEE12LMA3C	12	M16 x 1.5	315	420	£0.00
H0117-2996	WEE15LMA3C	15	M18 x 1.5	315	420	£0.00
H0117-2997	WEE18LMA3C	18	M22 x 1.5	250	400	£0.00
H0117-2998	WEE22LM27X2A3C	22	M27 x 2	160	250	£0.00
H0117-2999	WEE28LMA3C	28	M33 x 2	160	250	£0.00
H0117-3000	WEE35LMA3C	35	M42 x 2	160	250	£0.00
H0117-3001	WEE42LMA3C	42	M48 x 2	160	250	£0.00
<b>Heavy Duty</b>						
H0117-3002	WEE06-SMA3C	6	M12 x 1.5	315	500	£0.00
H0117-3003	WEE08SMA3C	8	M14 x 1.5	315	500	£0.00
H0117-3004	WEE10SMA3C	10	M16 x 1.5	315	500	£0.00
H0117-3005	WEE12SMA3C	12	M18 x 1.5	315	500	£0.00
H0117-3006	WEE16SMA3C	16	M22 x 1.5	250	400	£0.00
H0117-3007	WEE20SMA3C	20	M27 x 2	250	400	£0.00
H0117-3008	WEE25SMA3C	25	M33 x 2	160	250	£0.00
H0117-3009	WEE30SMA3C	30	M42 x 2	160	250	£0.00
H0117-3010	WEE38SMA3C	38	M48 x 2	160	250	£0.00

**VEE-M Male Stud 45° Elbow, Adjustable Locknut**

EO tube end / Male metric parallel thread

- ISO 6149 with O - ring seal

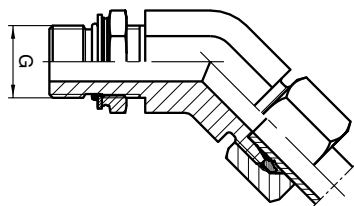

Code	Tube O.D. (mm)	Male Thread Metric G	PN (bar)	P max (bar)	Price	
<b>Light series</b>						
H0117-2973	VEE06LMA3C	6	m10 x 1	315	420	£0.00
H0117-2974	VEE08LMA3C	8	m12 x 1.5	315	420	£0.00
H0117-2975	VEE10LMA3C	10	m14 x 1.5	315	420	£0.00
H0117-2976	VEE12LMA3C	12	m16 x 1.5	315	420	£0.00
H0117-2977	VEE15LMA3C	15	m18 x 1.5	315	420	£0.00
H0117-2978	VEE18LMA3C	18	m22 x 1.5	315	420	£0.00
H0117-2979	VEE22LM27X2A3C	22	m27 x 2	160	250	£0.00
H0117-2980	VEE28LMA3C	28	m33 x 2	160	250	£0.00
H0117-2981	VEE35LMA3C	35	m42 x 2	160	250	£0.00
H0117-2982	VEE42LMA3C	42	m48 x 2	160	250	£0.00
<b>Standard series</b>						
H0117-2983	VEE06SMA3C	6	m12 x 1.5	400	630	£0.00
H0117-2984	VEE08SMA3C	8	m14 x 1.5	400	630	£0.00
H0117-2985	VEE10SMA3C	10	m16 x 1.5	400	630	£0.00
H0117-2986	VEE12SMA3C	12	m18 x 1.5	400	630	£0.00
H0117-2987	VEE16SMA3C	16	m22 x 1.5	400	630	£0.00
H0117-2988	VEE20SMA3C	20	m27 x 2	400	630	£0.00
H0117-2989	VEE25SMA3C	25	m33 x 2	315	420	£0.00
H0117-2990	VEE30SMA3C	30	m42 x 2	250	400	£0.00
H0117-2991	VEE38SMA3C	38	m48 x 2	200	315	£0.00

**TEE-M Male Branch Tee, Adjustable Locknut**

EO tube end / Male metric parallel thread

- With O - ring seal for ports with small or wide spot face

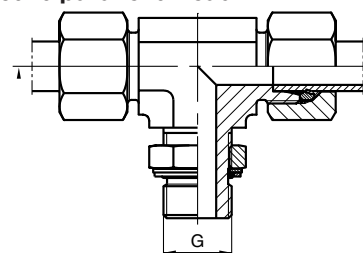

Code	Tube O.D. (mm)	Male Thread Metric G	PN (bar)	P max (bar)	Price	
<b>Light Duty</b>						
H0117-2954	TEE06LMA3C	6	m10 x 1	315	420	£0.00
H0117-2955	TEE08LMA3C	8	m12 x 1.5	315	420	£0.00
H0117-2956	TEE10LMA3C	10	m14 x 1.5	315	420	£0.00
H0117-2957	TEE12LMA3C	12	m16 x 1.5	315	420	£0.00
H0117-2958	TEE15LMA3C	15	m18 x 1.5	315	420	£0.00
H0117-2959	TEE18LMA3C	18	m22 x 1.5	250	400	£0.00
H0117-2960	TEE22LMA3C	22	m27 x 2	160	250	£0.00
H0117-2961	TEE28LMA3C	28	m33 x 2	160	250	£0.00
H0117-2962	TEE35LMA3C	35	m42 x 2	160	250	£0.00
H0117-2963	TEE42LMA3C	42	m48 x 2	160	250	£0.00
<b>Heavy Duty</b>						
H0117-2964	TEE06SMA3C	6	m12 x 1.5	315	500	£0.00
H0117-2965	TEE08SMA3C	8	m14 x 1.5	315	500	£0.00
H0117-2966	TEE10SMA3C	10	m16 x 1.5	315	500	£0.00
H0117-2967	TEE12SMA3C	12	m18 x 1.5	315	500	£0.00
H0117-2968	TEE16SMA3C	16	m22 x 1.5	250	400	£0.00
H0117-2969	TEE20SMA3C	20	m27 x 2	250	400	£0.00
H0117-2970	TEE25SMA3C	25	m33 x 2	160	250	£0.00
H0117-2971	TEE30SMA3C	30	m42 x 2	160	250	£0.00
H0117-2972	TEE38SMA3C	38	m48 x 2	160	250	£0.00

**LEE-M Adjustable Locknut Run Tee**

EO tube end / Male metric parallel thread

- With O - ring seal for ports with small or wide spot face

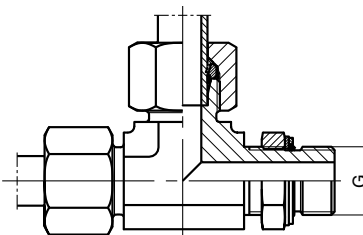

Code	Tube O.D. (mm)	Male Thread Metric G	PN (bar)	P max (bar)	Price	
<b>Light Duty</b>						
H0117-2744	LEE06LMA3C	6	m10 x 1	315	420	£9.00
H0117-2745	LEE08LMA3C	8	m12 x 1.5	315	420	£8.90
H0117-2789	LEE10LMA3C	10	m14 x 1.5	315	420	£10.39
H0117-2790	LEE12LMA3C	12	m16 x 1.5	315	420	£11.58
H0117-2791	LEE15LMA3C	15	m18 x 1.5	315	420	£13.96
H0117-2792	LEE18LMA3C	18	m22 x 1.5	250	400	£17.10
H0117-2793	LEE22LM27X2A3C	22	m27 x 2	160	250	£22.98
H0117-2794	LEE28LMA3C	28	m33 x 2	160	250	£42.83
H0117-2795	LEE35LMA3C	35	m42 x 2	160	250	£54.50
H0117-2796	LEE42LMA3C	42	m48 x 2	160	250	£66.60
<b>Heavy Duty</b>						
H0117-2805	LEE06SMA3C	6	m12 x 1.5	315	500	£8.89
H0117-2804	LEE08SMA3C	8	m14 x 1.5	315	500	£10.31
H0117-2803	LEE10SMA3C	10	m16 x 1.5	315	500	£11.58
H0117-2802	LEE12SMA3C	12	m18 x 1.5	315	500	£13.69
H0117-2801	LEE16SMA3C	16	m22 x 1.5	250	400	£17.26
H0117-2800	LEE20SMA3C	20	m27 x 2	250	400	£23.51
H0117-2799	LEE25SMA3C	25	m33 x 2	160	250	£43.79
H0117-2798	LEE30SMA3C	30	m42 x 2	160	250	£55.26
H0117-2797	LEE38SMA3C	38	m48 x 2	160	250	£70.10

Manufacturer's code EXAMPLE = Special Price

Locknut Adjustables

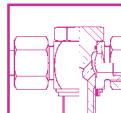

SECTION  
40

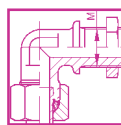

Online order  
www.lister.co.uk



## Tube to Metric Banjos

### SWVE-M Banjo Elbow Medium Pressure

EO tube end / Male metric parallel thread

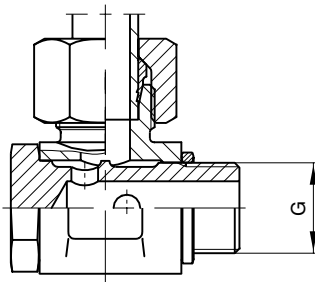

Code	Tube O.D. (mm)	Male Thread Metric G	PN (bar)	P max (bar)	Price	
<b>Extra Light Duty</b>						
H0117-1136	SWVE04LLMA3C	4	m8 x 1	63	100	£8.17
H0117-2908	SWVE06LLMA3C	6	m10 x 1	63	100	£8.06
H0117-1159	SWVE08LLMA3C	8	m10 x 1	63	100	£8.13
<b>Light Duty</b>						
H0117-1156	SWVE06LMA3C	6	m10 x 1	160	250	£6.99
H0117-1161	SWVE08LMA3C	8	m12 x 1.5	160	250	£7.90
H0117-1139	SWVE10LMA3C	10	m14 x 1.5	160	250	£8.46
H0117-1727	SWVE12LMA3C	12	m16 x 1.5	100	160	£9.92
H0117-1147	SWVE15LMA3C	15	m18 x 1.5	100	160	£11.56
H0117-2941	SWVE18LMA3C	18	m22 x 1.5	100	160	£0.00
H0117-2942	SWVE22LMA3C	22	m26 x 1.5	100	160	£0.00
<b>Heavy Duty</b>						
H0117-1137	SWVE06SMA3C	6	m12 x 1.5	160	250	£8.01
H0117-1138	SWVE08SMA3C	8	m14 x 1.5	160	250	£8.59
H0117-1141	SWVE10SMA3C	10	m16 x 1.5	100	250	£10.09
H0117-2943	SWVE12SMA3C	12	m18 x 1.5	100	160	£0.00
H0117-1145	SWVE14SMA3C	14	m20 x 1.5	100	160	£17.09
H0117-1149	SWVE16SMA3C	16	m22 x 1.5	100	160	£16.31
H0117-2944	SWVE20SMA3C	20	m27 x 2	100	160	£0.00

### WH-M-KDS Banjo Elbow High Pressure

EO tube end / Male metric parallel thread

• With soft seal ring

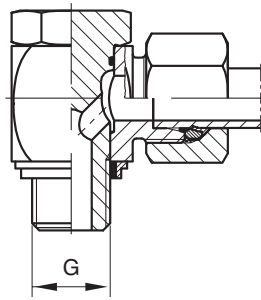

Code	Tube O.D. (mm)	Male Thread G	PN (bar)	P max (bar)	Price	
<b>Light Duty</b>						
H0117-2626	WH06LMKDSA3C	6	m10 x 1	315	400	£8.76
H0117-1470	WH08LMKDSA3C	8	m12 x 1.5	315	400	£9.32
H0117-2580	WH10LMKDSA3C	10	m14 x 1.5	315	400	£9.70
H0117-2945	WH12LMKDSA3C	12	m16 x 1.5	315	400	£0.00
H0117-2453	WH15LMKDSA3C	15	m18 x 1.5	315	400	£14.10
H0117-2946	WH18LMKDSA3C	18	m22 x 1.5	315	400	£0.00
H0113-0411	WH22LMKDSA3C	22	m26 x 1.5	160	250	£28.63
H0117-2947	WH28LMKDSA3C	28	m33 x 2	160	250	£0.00
H0117-2948	WH35LMKDSA3C	35	m42 x 2	160	250	£0.00
H0117-2949	WH42LMKDSA3C	42	m48 x 2	160	250	£0.00
<b>Heavy Duty</b>						
H0117-2042	WH06SMKDSA3C	6	m12 x 1.5	400	500	£9.53
H0117-1635	WH08SMKDSA3C	8	m14 x 1.5	400	500	£9.85
H0117-2950	WH10SMKDSA3C	10	m16 x 1.5	400	500	£0.00
H0113-0409	WH12SMKDSA3C	12	m18 x 1.5	400	500	£13.74
H0113-0410	WH16SMKDSA3C	16	m22 x 1.5	315	400	£20.44
H0117-2951	WH20SMKDSA3C	20	m27 x 2	315	400	£0.00
H0117-1456	WH25SMKDSA3C	25	m33 x 2	250	315	£46.73
H0117-2952	WH30SMKDSA3C	30	m42 x 2	160	250	£0.00
H0117-2953	WH38SMKDSA3C	38	m48 x 2	160	250	£0.00

☰ = Manufacturer's code **EXAMPLE** = Special Price

## Tube to Metric Taper

### GE-M-KEG Male Stud Connector

EO tube end / Male metric tapered thread

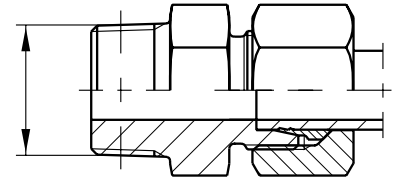

Code	Tube O.D. (mm)	Male Thread Metric G (tap)	PN (bar)	P max (bar)	Price	
<b>Extra Light Duty</b>						
H0117-1902	GE04LLM6X1KEGA3C	4	m6 x 1tap	100	250	£1.83
H0117-0719	GE04LLMA3C	4	m8 x 1tap	100	250	£1.02
H0117-0722	GE06LLMA3C	6	m10 x 1tap	100	250	£1.09
H0117-2910	GE06LLM8X1KEGA3C	6	m8 x 1tap	100	250	£2.69
H0117-0736	GE08LLMA3C	8	m10 x 1tap	100	250	£1.18

## Tube to UNF

### GE-UNF/UN Male Stud Connector

EO tube end / UNF/UN parallel thread

• With O - ring seal

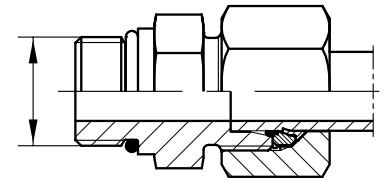

Code	Tube O.D. (mm)	UNF/UN parallel Thread G	PN (bar)	P max (bar)	Price	
<b>Light Duty</b>						
H0117-1665	GE08L7/16UNFA3C	8	7/16 - 20UNF	315	500	£8.43
H0117-0011	GE10L7/16UNFA3C	10	7/16 - 20UNF	315	500	£8.61
H0117-0009	GE12L9/16UNFA3C	12	9/16 - 18UNF	315	400	£8.89
H0117-0595	GE12L3/4UNFA3C	12	3/4 - 16UNF	315	400	£10.78
H0117-0006	GE12L7/8UNFA3C	12	7/8 - 14UNF	315	400	£12.16
H0117-1583	GE15L3/4UNFA3C	15	3/4 - 16UNF	315	400	£11.18
H0117-2591	GE15L7/8UNFA3C	15	7/8 - 14UNF	315	400	£12.56
H0117-1387	GE18L3/4UNFA3C	18	3/4 - 16UNF	315	400	£13.05
H0117-1500	GE18L7/8UNFA3C	18	7/8 - 14UNF	315	400	£13.97
H0117-1905	GE22L7/8UNFA3C	22	7/8 - 14UNF	160	250	£17.96
H0117-1903	GE22L11/16UNFA3C	22	1-1/16 - 12UN	160	250	£17.63
H0117-1904	GE22L15/16UNFA3C	22	1-5/16 - 12UN	160	250	£20.85
H0117-1907	GE28L11/16UNFA3C	28	1-1/16 - 12UN	160	250	£22.25
H0117-2598	GE28L15/16UNFA3C	28	1-5/16 - 12UN	160	250	£22.27
H0117-2597	GE35L15/16UNFA3C	35	1-5/16 - 12UN	160	250	£26.72
H0117-1927	GE35L15/8UNFA3C	35	1-5/8 - 12UN	160	250	£29.12
H0117-2909	GE42L15/8UNFA3C	42	1-5/8 - 12UN	160	250	£35.50
<b>Heavy Duty</b>						
H0117-1899	GE08S7/16UNFA3C	8	7/16 - 20UNF	630	900	£8.40
H0117-0001	GE10S9/16UNFA3C	10	9/16 - 18UNF	630	900	£9.36
H0117-0002	GE12S9/16UNFA3C	12	9/16 - 18UNF	630	900	£11.23
H0117-0008	GE12S3/4UNFA3C	12	3/4 - 16UNF	630	900	£11.89
H0117-1501	GE16S3/4UNFA3C	16	3/4 - 16UNF	400	630	£12.47
H0117-0027	GE16S7/8UNFA3C	16	7/8 - 14UNF	400	630	£15.32
H0117-1818	GE20S3/4UNFA3C	20	3/4 - 16UNF	400	630	£19.55
H0117-1819	GE20S7/8UNFA3C	20	7/8 - 14UNF	400	630	£19.59
H0117-1817	GE20S11/16UNFA3C	20	1-1/16 - 12UN	400	630	£19.46
H0117-1906	GE25S11/16UNFA3C	25	1-1/16 - 12UN	400	630	£24.49
H0117-2911	GE25S15/16UNFA3C	25	1-5/16 - 12UN	400	630	£25.65
H0117-1632	GE30S11/16UNFA3C	30	1-5/16 - 12UN	400	420	£29.33
H0117-1908	GE30S15/8UNFA3C	30	1-5/8 - 12UN	400	420	£32.51
H0117-1910	GE38S15/8UNFA3C	38	1-5/8 - 12UN	315	420	£40.86

Tube connectors

SECTION  
40

Technical Helpline  
0845 120 9891

**Port Reducers**

**RI-ED Thread Reducer/Expander**

Male BSPP thread with Eolastic seal ED/Female BSPP

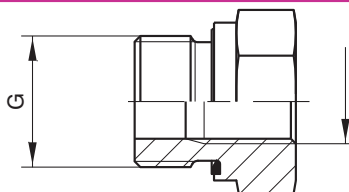

EO Fittings								EO-2 Fittings		
Code		Price	Male stud BSP G	Female thread BSP d1	PN (bar)	P max (bar)	Code		Price	
HO117-1803		£2.60	1/8	1/4	400	630	HO117-1803		£2.60	
HO117-1871		£4.83	1/8	3/8	400	630	HO117-1871		£4.83	
HO117-1867		£1.52	1/4	1/8	400	630	HO117-1867		£1.52	
HO117-1869		£2.22	1/4	3/8	400	630	HO117-1869		£2.22	
HO117-1866		£2.54	1/4	1/2	400	630	HO117-1866		£2.54	
HO117-1633		£9.12	1/4	3/4	400	630	HO117-1633		£9.12	
HO117-1872		£1.68	3/8	1/8	400	630	HO117-1872		£1.68	
HO117-1873		£1.61	3/8	1/4	400	630	HO117-1873		£1.61	
HO117-1874		£2.63	3/8	1/2	400	630	HO117-1874		£2.63	
HO117-1875		£7.74	3/8	3/4	315	400	HO117-1875		£7.74	
HO117-1863		£2.41	1/2	1/8	400	630	HO117-1863		£2.41	
HO117-1813		£1.82	1/2	1/4	400	630	HO117-1813		£1.82	
HO117-1865		£2.15	1/2	3/8	400	630	HO117-1865		£2.15	
HO117-1864		£6.98	1/2	3/4	315	400	HO117-1864		£6.98	
HO117-1861		£7.35	1/2	1"	315	400	HO117-1861		£7.35	
HO117-1862		£23.67	1/2	1-1/4	315	400	HO117-1862		£23.67	
HO117-1876		£2.69	3/4	1/4	315	400	HO117-1876		£2.69	
HO117-1877		£2.64	3/4	3/8	315	400	HO117-1877		£2.64	
HO117-1878		£3.20	3/4	1/2	315	400	HO117-1878		£3.20	
HO117-1879		£7.70	3/4	1"	315	400	HO117-1879		£7.70	
HO117-1814		£23.92	3/4	1-1/4	315	400	HO117-1814		£23.92	
HO117-1880		£28.58	3/4	1-1/2	250	315	HO117-1880		£28.58	
HO117-1881		£5.74	1"	1/4	315	400	HO117-1881		£5.74	
HO117-1882		£5.74	1"	3/8	315	400	HO117-1882		£5.74	
HO117-1883		£4.49	1"	1/2	315	400	HO117-1883		£4.49	
HO117-1884		£5.76	1"	3/4	315	400	HO117-1884		£5.76	
HO117-1885		£24.37	1"	1-1/4	315	400	HO117-1885		£24.37	
HO117-1812		£26.53	1"	1-1/2	250	315	HO117-1812		£26.53	
HO117-1809		£11.48	1-1/4	1/2	315	400	HO117-1809		£11.48	
HO117-1810		£8.12	1-1/4	3/4	315	400	HO117-1810		£8.12	
HO117-1811		£10.27	1-1/4	1"	315	400	HO117-1811		£10.27	
HO117-1808		£32.19	1-1/4	1-1/2	250	315	HO117-1808		£32.19	
HO117-1807		£22.30	1-1/2	1/2	250	315	HO117-1807		£22.30	
HO117-1806		£11.89	1-1/2	3/4	250	315	HO117-1806		£11.89	
HO117-1805		£11.96	1-1/2	1"	250	315	HO117-1805		£11.96	
HO117-1804		£17.11	1-1/2	1-1/4	250	315	HO117-1804		£17.11	
HO117-1886		£71.40	2"	1-1/2	160	250	HO117-1886		£71.40	

**Cone Plugs**

**VKA Blanking plug for cones**

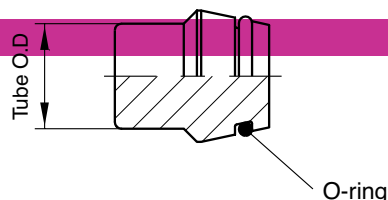

EO Fittings						EO-2 Fittings		
Code		Price	Tube O.D. (mm)	PN (bar)	P max (bar)	Code		Price
<b>Light Duty</b>								
HO117-1292		£0.54	6	315	500	HO117-1292		£0.54
HO117-1293		£0.65	8	315	500	HO117-1293		£0.65
HO117-1269		£0.70	10	315	500	HO117-1269		£0.70
HO117-1270		£0.87	12	315	400	HO117-1270		£0.87
HO117-1272		£1.14	15	315	400	HO117-1272		£1.14
HO117-1274		£1.24	18	315	400	HO117-1274		£1.24
HO117-1276		£1.94	22	160	250	HO117-1276		£1.94
HO117-1278		£3.16	28	160	250	HO117-1278		£3.16
HO117-1286		£6.22	35	160	250	HO117-1286		£6.22
HO117-1291		£9.62	42	160	250	HO117-1291		£9.62
<b>Heavy Duty</b>								
HO117-1292		£0.54	6	630	900	HO117-1292		£0.54
HO117-1293		£0.65	8	630	900	HO117-1293		£0.65
HO117-1269		£0.70	10	630	900	HO117-1269		£0.70
HO117-1270		£0.87	12	630	900	HO117-1270		£0.87
HO117-1271		£2.14	14	630	700	HO117-1271		£2.14
HO117-1273		£1.21	16	400	630	HO117-1273		£1.21
HO117-1275		£1.85	20	400	630	HO117-1275		£1.85
HO117-1277		£2.52	25	400	630	HO117-1277		£2.52
HO117-1279		£4.37	30	400	420	HO117-1279		£4.37
HO117-1288		£8.06	38	315	420	HO117-1288		£8.06

= Manufacturer's code **EXAMPLE** = Special Price

**Reducers & Plugs**

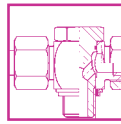

**SECTION**  
**40**

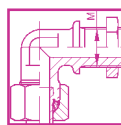

**Online Order**  
[www.lister.co.uk](http://www.lister.co.uk)



## Port & Tube Plugs



### VSTI R - ED Blanking plug for Ports - BSPP

With Eolastic sealing ED

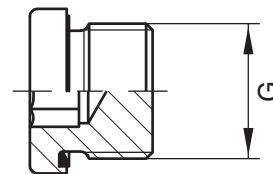

EO Fittings		
Code	Manufacturer's code	Price
HO117-1350	VST11/8EDA3C	£1.07
HO117-1349	VST11/4EDA3C	£1.17
HO117-1353	VST13/8EDA3C	£1.32
HO117-1348	VST11/2EDA3C	£1.90
HO117-1352	VST13/4EDA3C	£2.42
HO117-1351	VST11EDA3C	£4.69
HO117-1888	VST11/4EDA3C	£7.94
HO117-1887	VST11/2EDA3C	£9.12

EO-2 Fittings		
Code	Manufacturer's code	Price
HO117-1350	VST11/8EDA3C	£1.07
HO117-1349	VST11/4EDA3C	£1.17
HO117-1353	VST13/8EDA3C	£1.32
HO117-1348	VST11/2EDA3C	£1.90
HO117-1352	VST13/4EDA3C	£2.42
HO117-1351	VST11EDA3C	£4.69
HO117-1888	VST11/4EDA3C	£7.94
HO117-1887	VST11/2EDA3C	£9.12

### VSTI M - ED Blanking plug for Ports - Metric

With Eolastic sealing ED

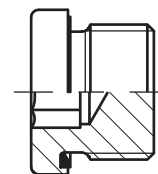

Code	Manufacturer's code	Male metric parallel thread G	PN (bar)	P max (bar)	Price
HO117-2583	VST110X1EDA3C	m 10 x 1	400	500	£1.31
HO117-1793	VST112X1.5EDA3C	m 12 x 1.5	400	500	£1.73
HO117-1334	VST114X1.5EDA3C	m 14 x 1.5	400	500	£1.90
HO117-1335	VST116X1.5EDA3C	m 16 x 1.5	400	500	£2.23
HO117-1336	VST118X1.5EDA3C	m 18 x 1.5	400	500	£2.21
HO117-2055	VST120X1.5EDA3C	m 20 x 1.5	400	500	£3.01
HO117-2565	VST122X1.5EDA3C	m 22 x 1.5	400	500	£2.81
HO117-2584	VST126X1.5EDA3C	m 26 x 1.5	400	500	£4.15
HO117-1341	VST127X2EDA3C	m 27 x 2	400	500	£3.69
HO117-1342	VST133X2EDA3C	m 33 x 2	400	500	£4.88
HO117-1344	VST142X2EDA3C	m 42 x 2	315	400	£6.81
HO117-1346	VST148X2EDA3C	m 48 x 2	315	400	£9.69

### ROV Blanking plug for tube ends

EO tube end

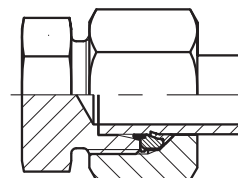

EO Fittings		
Code	Manufacturer's code	Price
HO117-1054	ROV06LA3C	£2.04
HO117-1055	ROV08LA3C	£2.34
HO117-1056	ROV10LA3C	£2.70
HO117-1059	ROV12LA3C	£3.21
HO117-1061	ROV15LA3C	£4.46
HO117-1063	ROV18LA3C	£6.77
HO117-2615	ROV22LA3C	£9.48
HO117-2618	ROV28LA3C	£16.77
HO117-2619	ROV35LA3C	£24.96
HO117-2620	ROV42LA3C	£34.73
<b>Heavy Duty</b>		
HO117-2892	ROV06SA3C	£2.38
HO117-2659	ROV08SA3C	£2.77
HO117-1057	ROV10SA3C	£3.28
HO117-1060	ROV12SA3C	£3.83
HO117-2893	ROV14SA3C	£6.81
HO117-1062	ROV16SA3C	£7.17
HO117-1598	ROV20SA3C	£10.68
HO117-1726	ROV25SA3C	£17.41
HO117-2622	ROV30SA3C	£25.44
HO117-2621	ROV38SA3C	£36.80

EO-2 Fittings		
Code	Manufacturer's code	Price
HO113-0602	ROV06ZLA3C	£2.82
HO113-0608	ROV08ZLA3C	£3.17
HO113-0595	ROV10ZLA3C	£3.75
HO113-0596	ROV12ZLA3C	£4.34
HO113-0597	ROV15ZLA3C	£5.95
HO113-0598	ROV18ZLA3C	£9.03
HO113-0599	ROV22ZLA3C	£20.27
HO113-0600	ROV28ZLA3C	£20.04
HO113-0601	ROV35ZLA3C	£30.90
HO113-0477	ROV42ZLA3C	£42.67
<b>Heavy Duty</b>		
HO117-2892	ROV06SA3C	£2.38
HO117-2659	ROV08SA3C	£2.77
HO117-1057	ROV10SA3C	£3.28
HO117-1060	ROV12SA3C	£3.83
HO117-2893	ROV14SA3C	£6.81
HO117-1062	ROV16SA3C	£7.17
HO117-1598	ROV20SA3C	£10.68
HO117-1726	ROV25SA3C	£17.41
HO117-2622	ROV30SA3C	£25.44
HO117-2621	ROV38SA3C	£36.80

Manufacturer's code EXAMPLE = Special Price

Port & Tube Plugs

SECTION

40

Technical Helpline  
0845 120 9891



## Support Sleeves

### VH Tube insert

For thin-walled metal tubing



Code	Icon	Tube I.D. (mm)	Price
HD117-1986	VH04A3CX	4.0	£0.34
HD117-1985	VH04.5A3CX	4.5	£0.70
HD117-2274	VH05A3CX	5.0	£0.36
HD117-2275	VH06A3CX	6.0	£0.46
HD117-2276	VH07A3CX	7.0	£0.46
HD117-2277	VH08A3CX	8.0	£0.49
HD117-2278	VH09A3CX	9.0	£0.57
HD117-2279	VH10A3CX	10.0	£0.63
HD117-2280	VH12A3CX	12.0	£0.85
HD117-2281	VH13A3CX	13.0	£0.78
HD117-2282	VH14A3CX	14.0	£1.37
HD117-2417	VH15A3CX	15.0	£0.98
HD117-2419	VH16A3CX	16.0	£0.98
HD117-2871	VH17A3CX	17.0	£2.66
HD117-2418	VH18A3CX	18.0	£2.49
HD117-1266	VH19A3CX	19.0	£0.91
HD117-1267	VH20A3CX	20.0	£1.11
HD117-1264	VH21A3CX	21.0	£1.85
HD117-1268	VH22A3CX	22.0	£2.39
HD117-2423	VH24A3CX	24.0	£1.78
HD117-2420	VH25A3CX	25.0	£1.64
HD117-2872	VH26A3CX	26.0	£1.96
HD117-2873	VH27A3CX	27.0	£4.27
HD117-2876	VH30A3CX	30.0	£4.41
HD117-2421	VH31A3CX	31.0	£4.28
HD117-2875	VH32A3CX	32.0	£4.38
HD117-2874	VH33A3CX	33.0	£9.16
HD117-2422	VH38A3CX	38.0	£5.91

### E Tube insert

For plastic tubing - BRASS

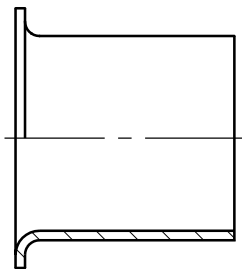

Code	Icon	Tube O.D. (mm)	Tube I.D. (mm)	Price
HD117-0179	E04/02X	4.0	2.0	£0.13
HD117-2901	E04/2.5X	4.0	2.5	£0.13
HD117-0182	E0506/04X	5.0	4.0	£0.14
HD117-0182	E0506/04X	6.0	4.0	£0.14
HD117-0186	E08/05X	8.0	5.0	£0.21
HD117-0184	E0810/06X	10.0	6.0	£0.31
HD117-0184	E0810/06X	8.0	6.0	£0.31
HD117-0172	E10/08X	10.0	8.0	£0.35
HD117-1661	E12/08X	12.0	8.0	£0.00
HD117-0174	E12/09X	12.0	9.0	£0.45
HD117-0173	E1215/10X	12.0	10.0	£0.45
HD117-0175	E15/12X	15.0	12.0	£0.53
HD117-2365	E1516/12.5X	15.0	12.5	£0.60
HD117-2365	E1516/12.5X	16.0	12.5	£0.60
HD117-0177	E18/14X	18.0	14.0	£0.63
HD117-2899	E1820/16X	18.0	16.0	£0.92
HD117-2899	E1820/16X	20.0	16.0	£0.92
HD117-0178	E22/18X	22.0	18.0	£0.86

Icon = Manufacturer's code **EXAMPLE** = Special Price

## Test Points



### EMA3 Test Point with threaded connection m16 x 2

Male thread: BSP & Metric

- Sealing: O - ring, fig. A ; Eolastic sealing, fig. B and C ; Cutting face, fig. D and E.
- Form A = Image a
- Form B = Eolastic Sealing
- Form D = Cutting Face
- Form E = Cutting Face
- Form F = O-ring

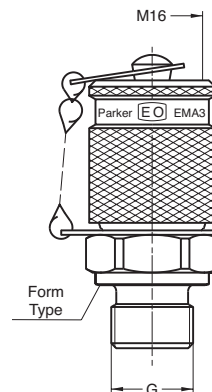

Code	Icon	Male Thread	Form	PN (bar)	P max (bar)	Price
HD117-0266	EMA3/M8X10R	m8 x 1	A	630	700	£
HD117-3011	EMA3/M10X10R	m10 x 1	A	630	700	£9.57
HD117-0265	EMA3/M14X1.5ISO	m14 x 1.5	F	630	700	£0.00
HD117-0265	EMA3/M10X1	m10 x 1	D	400	630	£11.81
HD117-2290	EMA3/M12X1.5	m12 x 1.5	D	400	630	£9.92
HD117-2121	EMA3/M14X1.5	m14 x 1.5	D	400	630	£10.37
HD117-2923	EMA3/M16X1.5	m16 x 1.5	D	400	630	£0.00
HD117-0270	EMA3/1/8	1/8	D	400	630	£10.02
HD117-0268	EMA3/1/4	1/4	D	400	630	£10.42
HD117-2109	EMA3/3/8	3/8	E	400	630	£11.47
HD117-0267	EMA3/1/2	1/2	E	400	630	£14.54
HD117-2456	EMA3/1/8ED	1/8	B	630	700	£9.72
HD117-0269	EMA3/1/4ED	1/4	B	630	700	£9.72
HD117-0271	EMA3/3/8ED	3/8	B	630	700	£11.01
HD117-2724	EMA3/M10X1ED	m10 x 1	B	630	700	£9.82
HD117-2317	EMA3/M12X1.5ED	m12 x 1.5	B	630	700	£9.92
HD117-2692	EMA3/M14X1.5ED	m14 x 1.5	B	400	630	£9.82

### MAV/MA3 - Test Point Pressure Gauge Connector with threaded connection m16 x 2

- Female thread: BSP
- Sealing: sealing ring DIN 16258°

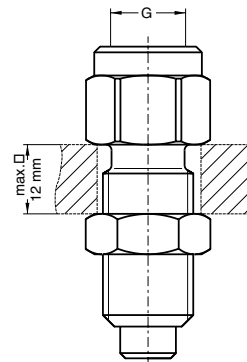

Code	Icon	Female Thread G	PN (bar)	P max (bar)	Price
HD117-0947	MAV1/4MA3	1/4	630	700	£9.32
HD117-0943	MAV1/2MA3	1/2	630	700	£10.17

### SMA3 Test Point High Pressure Hose

With threaded connection M16 x 2

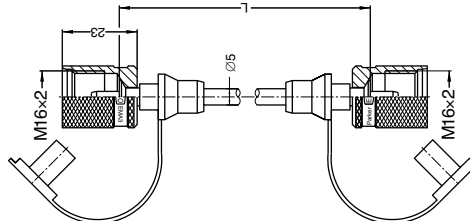

Code	Icon	Length (mm) L	Price
HD117-2897	SMA3-300	300	£12.54
HD117-1100	SMA3-400	400	£13.29
HD117-1101	SMA3-630	630	£13.84
HD117-1102	SMA3-800	800	£15.02
HD117-1096	SMA3-1000	1000	£15.91

Available in any length required. Please ring for details.

Test Points

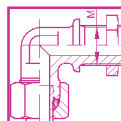
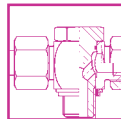

Online Order  
www.lister.co.uk



## Weld Fitting

### AS Weld Connector

EO tube end / Butt Weld

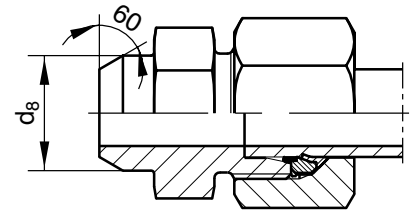

#### EO Fittings

Code	Manufacturer's Code	Price	Tube O.D. (mm)	PN (bar)	P max (bar)	d8 (mm)
<b>Light Series</b>						
H0117-0034	AS06L	£1.45	06	315	500	10
H0117-0036	AS08L	£1.72	08	315	500	12
H0117-0038	AS10L	£2.00	10	315	500	14
H0117-0040	AS12L	£2.20	12	315	400	16
H0117-0043	AS15L	£2.80	15	315	400	19
H0117-0045	AS18L	£3.89	18	315	400	22
H0117-0047	AS22L	£5.67	22	160	250	27
H0117-0049	AS28L	£10.89	28	160	250	32
H0117-0051	AS35L	£14.15	35	160	250	40
H0117-0053	AS42L	£19.04	42	160	250	46
<b>Heavy Series</b>						
H0117-0035	AS06S	£1.90	06	630	900	11
H0117-0037	AS08S	£2.23	08	630	900	13
H0117-0039	AS10S	£2.55	10	630	900	15
H0117-0041	AS12S	£2.98	12	630	900	17
H0117-0042	AS14S	£4.70	14	630	700	19
H0117-0044	AS16S	£4.38	16	400	630	21
H0117-0046	AS20S	£6.37	20	400	630	26
H0117-0048	AS25S	£10.44	25	400	630	31
H0117-0050	AS30S	£15.90	30	400	420	36
H0117-0052	AS38S	£21.70	38	315	420	44

#### EO-2 Fittings

Code	Manufacturer's Code	Price
H0113-0733	AS06ZL	£2.25
H0113-0004	AS08ZL	£2.57
H0113-0005	AS10ZL	£3.07
H0113-0734	AS12ZL	£3.37
H0113-0006	AS15ZL	£4.32
H0113-0735	AS18ZL	£6.24
H0113-0736	AS22ZL	£8.56
H0113-0737	AS28ZL	£13.46
H0113-0738	AS35ZL	£20.21
H0113-0739	AS42ZL	£20.21
H0113-0731	AS06ZS	£2.86
H0113-0740	AS08ZS	£3.15
H0113-0741	AS10ZS	£3.56
H0113-0742	AS12ZS	£4.29
H0113-0743	AS14ZS	£7.33
H0113-0007	AS16ZS	£6.45
H0113-0744	AS20ZS	£8.90
H0113-0008	AS25ZS	£14.26
H0113-0009	AS30ZS	£19.97
H0113-0010	AS38ZS	£28.52

### WAS Weld Elbow

EO tube end / Butt Weld

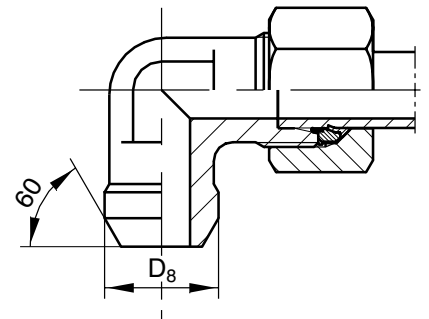

#### EO Fittings

Code	Manufacturer's Code	Price	Tube O.D. (mm)	PN (bar)	P max (bar)	D8 (mm)
<b>Light Series</b>						
H0117-3031	WAS06L	£4.49	06	315	500	10
H0117-3033	WAS08L	£4.69	08	315	500	12
H0117-3035	WAS10L	£4.90	10	315	500	14
H0117-3037	WAS12L	£5.92	12	315	400	16
H0117-3039	WAS15L	£7.32	15	315	400	19
H0117-3041	WAS18L	£10.36	18	315	400	22
H0117-3043	WAS22L	£13.24	22	160	250	27
H0117-3045	WAS28L	£20.33	28	160	250	32
H0117-3047	WAS35L	£29.70	35	160	250	40
H0117-3049	WAS42L	£35.97	42	160	250	46
<b>Heavy Series</b>						
H0117-3051	WAS06S	£4.88	06	630	900	11
H0117-3053	WAS08S	£6.57	08	630	900	13
H0117-3055	WAS10S	£6.84	10	630	900	15
H0117-3057	WAS12S	£7.35	12	630	900	17
H0117-3059	WAS14S	£8.69	14	630	700	19
H0117-3061	WAS16S	£10.81	16	400	630	21
H0117-3063	WAS20S	£18.12	20	400	500	26
H0117-3065	WAS25S	£21.55	25	400	500	31
H0117-3067	WAS30S	£30.94	30	400	420	36
H0117-3069	WAS38S	£40.94	38	315	420	44

#### EO-2 Fittings

Code	Manufacturer's Code	Price
H0113-0745	WAS06ZL	£5.19
H0113-0746	WAS08ZL	£5.45
H0113-0747	WAS10ZL	£5.89
H0113-0748	WAS12ZL	£6.96
H0113-0749	WAS15ZL	£8.70
H0113-0750	WAS18ZL	£12.51
H0113-0751	WAS22ZL	£16.15
H0113-0752	WAS28ZL	£23.39
H0113-0753	WAS35ZL	£35.59
H0113-0754	WAS42ZL	£43.89
H0113-0682	WAS06ZS	£5.73
H0113-0627	WAS08ZS	£7.43
H0113-0629	WAS10ZS	£7.80
H0113-0630	WAS12ZS	£8.52
H0113-0631	WAS14ZS	£11.43
H0113-0632	WAS16ZS	£12.68
H0113-0633	WAS20ZS	£20.07
H0113-0634	WAS25ZS	£25.05
H0113-0635	WAS30ZS	£36.14
H0113-0636	WAS38ZS	£47.53

☒ = Manufacturer's code **EXAMPLE** = Special Price

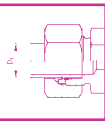

SECTION  
40



Technical Helpline  
0845 120 9891



**Weld Fitting**

**ESV Weld Bulkhead Fitting**

EO tube end / EO tube end

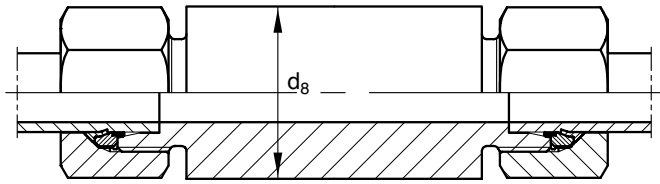

EO Fittings							EO-2 Fittings		
Code		Price	Tube O.D. (mm)	PN (bar)	P max (bar)	d8 (mm)	Code		Price
<b>Light Series</b>									
H0117-0272	ESV06L	£7.78	06	315	500	18	H0113-0686	ESV06ZL	£8.88
H0117-0274	ESV08L	£8.05	08	315	500	20	H0113-0687	ESV08ZL	£9.50
H0117-0276	ESV10L	£8.13	10	315	500	22	H0113-0688	ESV10ZL	£10.15
H0117-0278	ESV12L	£10.56	12	315	400	25	H0113-0689	ESV12ZL	£12.55
H0117-0281	ESV15L	£11.20	15	315	400	28	H0113-0690	ESV15ZL	£14.08
H0117-0283	ESV18L	£14.95	18	315	400	32	H0113-0691	ESV18ZL	£19.43
H0117-0285	ESV22L	£19.57	22	160	250	36	H0113-0692	ESV22ZL	£25.07
H0117-0287	ESV28L	£24.84	28	160	250	40	H0113-0693	ESV28ZL	£31.48
H0117-0289	ESV35L	£33.94	35	160	250	50	H0113-0694	ESV35ZL	£46.00
H0117-0291	ESV42L	£49.08	42	160	250	60	H0113-0695	ESV42ZL	£65.18
<b>Heavy Series</b>									
H0117-0273	ESV06S	£9.08	06	630	900	20	H0113-0685	ESV06ZS	£10.62
H0117-0275	ESV08S	£9.65	08	630	900	22	H0113-0684	ESV08ZS	£11.33
H0117-0277	ESV10S	£10.56	10	630	900	25	H0113-0043	ESV10ZS	£12.41
H0117-0279	ESV12S	£11.03	12	630	900	28	H0113-0044	ESV12ZS	£13.49
H0117-0280	ESV14S	£16.94	14	630	700	30	H0113-0628	ESV14ZS	£21.97
H0117-0282	ESV16S	£16.36	16	400	630	35	H0113-0045	ESV16ZS	£20.26
H0117-0284	ESV20S	£20.85	20	400	630	38	H0113-0046	ESV20ZS	£25.66
H0117-0286	ESV25S	£26.99	25	400	630	45	H0113-0047	ESV25ZS	£34.57
H0117-0288	ESV30S	£33.98	30	400	420	50	H0113-0048	ESV30ZS	£44.71
H0117-0290	ESV38S	£52.11	38	315	420	60	H0113-0683	ESV38ZS	£65.63

**Weld Fittings**

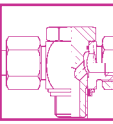

**SECTION**  
**40**

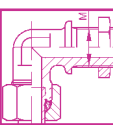

**Online Order**  
[www.lister.co.uk](http://www.lister.co.uk)

= Manufacturer's code **EXAMPLE** = Special Price



## TUBE FITTINGS HIGH PRESSURE - ERMETO EO



### EO Nuts & Rings

#### M EO Nut

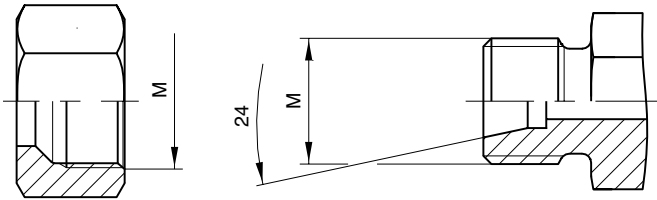

Code	Tube O.D. (mm)	Thread Size M	Price
<b>Very Light Duty</b>			
HD117-0932	M04LLA3CX	m8 x 1	£0.20
HD117-0934	M06LLA3CX	m10 x 1	£0.21
HD117-0937	M08LLA3CX	m12 x 1	£0.23
HD117-0915	M10LLA3CX	m14 x 1	£0.29
HD117-0918	M12LLA3CX	m16 x 1	£0.34
<b>Light Duty</b>			
HD117-0933	M06LA3CX	m12 x 1.5	£0.22
HD117-0936	M08LA3CX	m14 x 1.5	£0.27
HD117-0914	M10LA3CX	m16 x 1.5	£0.29
HD117-0917	M12LA3CX	m18 x 1.5	£0.37
HD117-0921	M15LA3CX	m22 x 1.5	£0.53
HD117-0923	M18LA3CX	m26 x 1.5	£0.97
HD117-0925	M22LA3CX	m30 x 2	£1.38
HD117-0927	M28LA3CX	m36 x 2	£2.56
HD117-0929	M35LA3CX	m45 x 2	£3.17
HD117-0931	M42LA3CX	m52 x 2	£3.27
<b>Heavy Duty</b>			
HD117-0935	M06SA3CX	m14 x 1.5	£0.27
HD117-0938	M08SA3CX	m16 x 1.5	£0.29
HD117-0916	M10SA3CX	m18 x 1.5	£0.42
HD117-0919	M12SA3CX	m20 x 1.5	£0.49
HD117-0920	M14SA3CX	m22 x 1.5	£0.74
HD117-0922	M16SA3CX	m24 x 1.5	£1.01
HD117-0924	M20SA3CX	m30 x 2	£1.55
HD117-0926	M25SA3CX	m36 x 2	£2.88
HD117-0928	M30SA3CX	m42 x 2	£3.55
HD117-0930	M38SA3CX	m52 x 2	£5.12

#### DPR Progressive ring - D Cutting ring

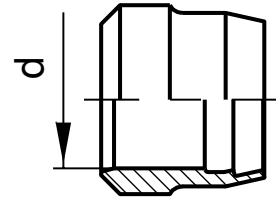

Code	Tube O.D. (mm)	Price
<b>Very Light Duty</b>		
HD117-0067	D04LLX	£0.23
HD117-0068	D06LLX	£0.23
HD117-0069	D08LLX	£0.23
HD117-0070	D10LLX	£0.27
HD117-0071	D12LLX	£0.29
<b>Light Duty</b>		
HD117-0136	DPRO6LX	£0.22
HD117-0137	DPRO8LX	£0.23
HD117-0138	DPR10LX	£0.28
HD117-0139	DPR12LX	£0.29
HD117-0141	DPR15LX	£0.34
HD117-0143	DPR18LX	£0.49
HD117-0145	DPR22LX	£0.59
HD117-0147	DPR28LX	£0.68
HD117-0149	DPR35LX	£1.09
HD117-0151	DPR42LX	£1.55
<b>Heavy Duty</b>		
HD117-0136	DPRO6SX	£0.22
HD117-0137	DPRO8SX	£0.23
HD117-0138	DPR10SX	£0.28
HD117-0139	DPR12SX	£0.29
HD117-0140	DPR14SX	£0.54
HD117-0142	DPR16SX	£0.54
HD117-0144	DPR20SX	£0.69
HD117-0146	DPR25SX	£0.84
HD117-0148	DPR30SX	£1.06
HD117-0150	DPR38SX	£1.45

## TUBE FITTINGS HIGH PRESSURE - ERMETO EO2



### EO2 Nuts

#### FM EO - 2 Functional Nut

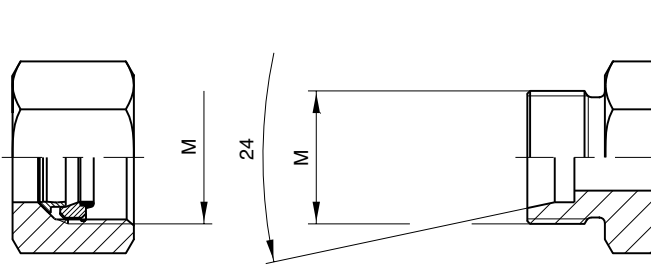

Code	Tube O.D. (mm)	Thread size M	Price
<b>Extra Light Duty</b>			
HD113-0082	FM04LLA3C	m8 x 1	£1.29
HD113-0378	FM06LLA3C	m10 x 1	£1.40
<b>Light Duty</b>			
HD113-0083	FM06LA3C	m12 x 1.5	£1.29
HD113-0085	FM08LA3C	m14 x 1.5	£1.40
HD113-0087	FM10LA3C	m16 x 1.5	£1.69
HD113-0089	FM12LA3C	m18 x 1.5	£1.89
HD113-0091	FM15LA3C	m22 x 1.5	£2.47
HD113-0093	FM18LA3C	m26 x 1.5	£3.92
HD113-0095	FM22LA3C	m30 x 2	£5.00
HD113-0097	FM28LA3C	m36 x 2	£6.70
HD113-0099	FM35LA3C	m45 x 2	£10.49
HD113-0101	FM42LA3C	m52 x 2	£13.18
<b>Heavy Duty</b>			
HD113-0084	FM06SA3C	m14 x 1.5	£1.39
HD113-0086	FM08SA3C	m16 x 1.5	£1.51
HD113-0088	FM10SA3C	m18 x 1.5	£1.77
HD113-0090	FM12SA3C	m20 x 1.5	£2.17
HD113-0550	FM14SA3C	m22 x 1.5	£4.04
HD113-0092	FM16SA3C	m24 x 1.5	£3.73
HD113-0094	FM20SA3C	m30 x 2	£4.92
HD113-0096	FM25SA3C	m36 x 2	£7.66
HD113-0098	FM30SA3C	m42 x 2	£10.18
HD113-0100	FM38SA3C	m52 x 2	£13.63

☛ = Manufacturer's code **EXAMPLE** = Special Price

EO Nuts & Rings / EO2 Nuts

SECTION  
40

Technical Helpline  
0845 120 9891